

HÄFELE



www.hafeleindia.com

FREE LIFT SYSTEMS



NEW FREEDOM IN MOTION. FREE.

LIFT SYSTEMS BY HÄFELE

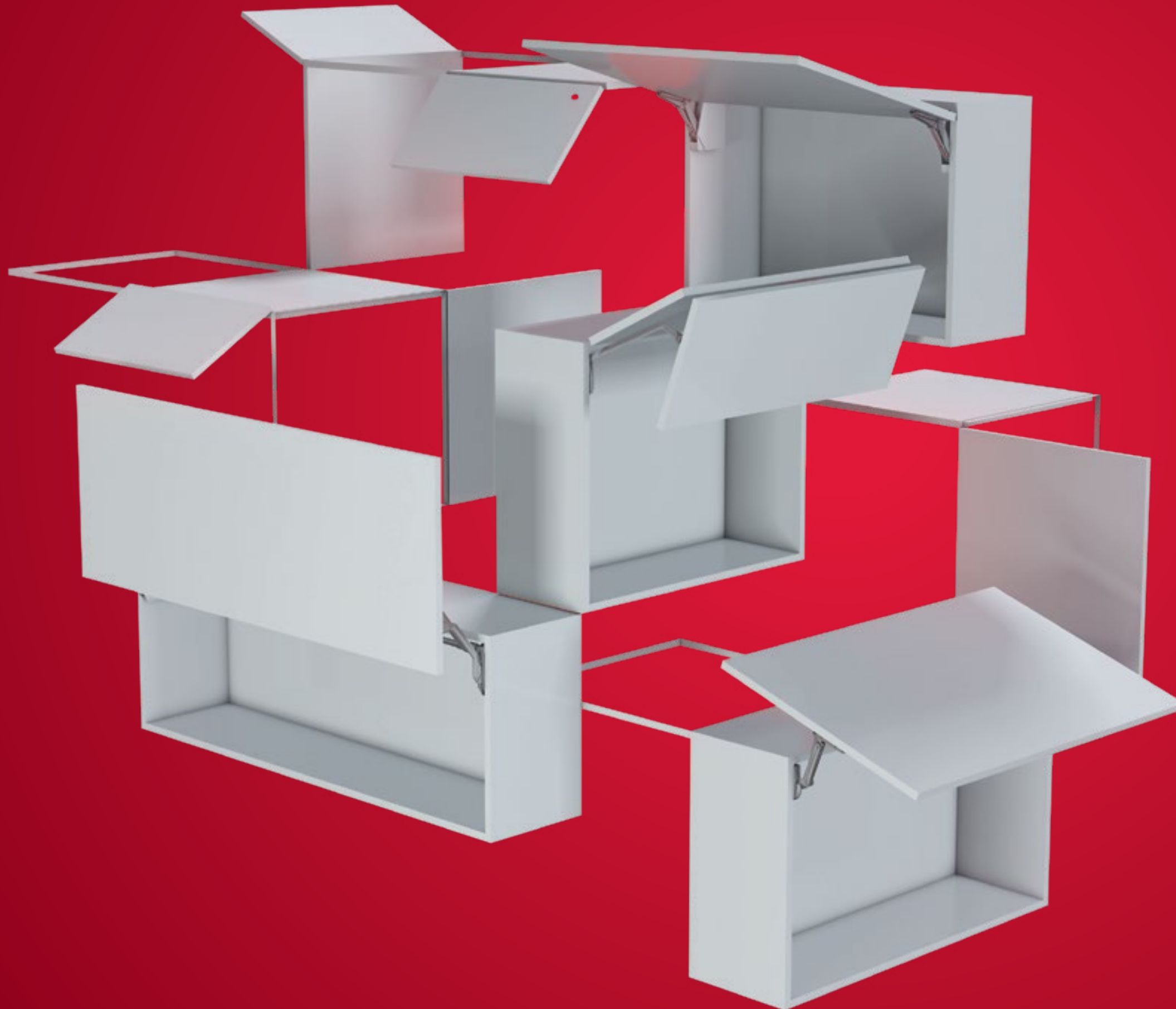

THE ELEGANCE OF OPENING.
FLAPS FOR MAXIMUM FREEDOM IN MOTION.
ENGINEERED BY HÄFELE.

The fittings of the Free family give flaps new freedom in movement. This opens up more opportunities in the visual and technical design of furniture and has tangible benefits compared to hinged doors. But above all, it gives the furniture and the room undreamt elegance and lightness. It doesn't matter whether a flap is lifted, tilted, swivelled, or folded – it immediately provides added value and more efficiency when working.

Almost 100 years of experience with furniture fittings, engineering expertise, and a close connection to the market and the people who work with furniture fittings on a daily basis led to the development of this product family. Inspired by the requirements of the market of tomorrow, the Free family fulfils the demands for creative freedom, choice of material, design, ease of installation and convenient operation on a whole new level. Having cycle tested for 80,000 times, these systems meet and even exceed the LGA certification requirements. To put it simply: They are slimmer (with regard to design), lighter (to operate) and simpler (to install).



ELEGANT MOTION IN THE ROOM.



HINGE AND LID
STAY IN ONE.



MAXIMUM ACCESS
TO THE CABINET.



ENGINEERED
BY **HAFELE**

MINIMAL SPACE REQUIREMENT.

FREE LIFT SYSTEMS

More Design Freedom. More Application Possibilities.

Large fronts need a lot of room to move using conventional types of opening. The Free lift systems vary the flap opening geometry in a creative way. So that the type of opening is geared to the amount of available space or is suitable for the intended application.

Free flap 1.7 / Free flap 3.15



- > Häfele Free flap 1.7: Extremely suitable for small to medium-sized flaps
- > Häfele Free flap 3.15: Extremely suitable for large, heavy flaps in wall units
- > Featherlight opening
- > Hinge connection not required

Free fold



- > Ideal for high wall units with large front panels
- > Handle is always easily accessible, even with high front panels
- > Minimal space required inside the room
- > Material combination possible in the front panel design
- > Finger-safe thanks to patented finger protection of the connecting hinge

Free swing



- > Ideal for large, one-piece front panels
- > Swivels around cornice profiles and surface mounted lights
- > Cabinet contents are extremely easy to access
- > Cross bar can be shortened to individual cabinet widths

Free up



- > Ideal for larger units or wall units with front panels above
- > Also optimally suited for cabinets with cornices or side panels
- > Cross bar can be shortened to individual cabinet widths

Make the process of ordering your Free Lift Systems easy and faultless with the Häfele Configurator.



Scan this QR code to download the mobile application and Log in/Sign Up to access the Free Family Configurator.

Android



iOS



Then simply enter the specifications as directed by the interface to receive the list of article numbers you would need to order as per your unique requirements.

FREE LIFT SYSTEMS

SLIMMER : Space-saving Design



Free lift systems combine hinge and lid stay into one unit – this reduces not just the amount of space that the hardware requires in the cabinet but it also looks significantly more elegant. More room, due to the slimline, discreet fittings, increases the amount of usable space in the cabinet interior. The consistent development of the 3-spring system and the motion geometry of the fittings has resulted in a slimmer construction of the housing.

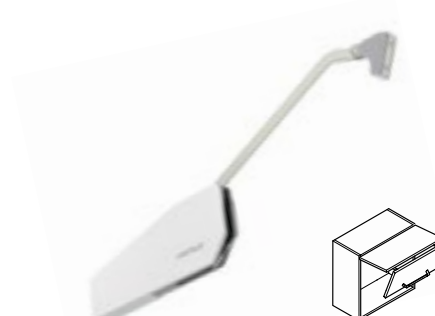

Free fold:
Only 288 mm wide and 25.5 mm slim



Free up:
Only 277 mm wide and 25.5 mm slim



Free swing:
Only 273 mm wide and 25.5 mm slim (without arm)

FREE LIFT SYSTEMS

LIGHTER: Easier Operations With Comfort

The main focus while developing the range was on providing maximum ease to the user. With the Free Lift Systems, Häfele has created new standards. The range turns opening and closing a cabinet into an experience.



1. FEATHER-LIGHT MOVEMENT

The flaps can be moved with a minimum amount of effort while opening or closing. This is possible even with heavy flaps.

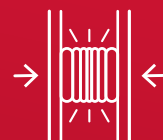

2. SOFT OPENING AND CLOSING

Undampened stops are a thing of the past. The final movement of the flaps is soft and silent in both directions.



3. MULTI-POSITION STOP

The flaps are held reliably in any position, regardless of the flap weight, making the handle reachable at all times.



4. CONVENIENT OPENING AND CLOSING

Electric motion support by Free E-Drive for maximum operating convenience. If required or necessary the flaps can always be operated manually.



5. PUSH-TO-OPEN

For front panels without handles - applying a slight pressure on the bottom of the front opens the flap slightly (in case of Free flap 1.7 and 3.15)



6. SAFETY-STOP (In Case of Free Fold)

The center hinges that connect the two parts of the Free fold flap feature a quick-release finger protection that prevents your fingers from getting caught or crushed.

FREE LIFT SYSTEMS

SIMPLER : Quicker Installation Saves Time

An impressive advantage of the Free family is its globally unique simple and quick installation. From one-handed installation and screw fixing of the fittings to clip-on mounting of the flaps, all working steps are optimized in such a way that the fitter saves a noticeable amount of time – for more efficiency.



DRILLING TEMPLATES:

Precise locating of the drill holes is made easier using the paper template provided with each fitting



UNIQUE BUILT-IN POSITIONING PINS:

For installing the fitting with a secure hold.



GLOBALY UNIQUE:
Can be installed with one hand.



SYMMETRICAL SCREW-ON BRACKETS:

For torsion-free fixing.



INSTALLATION WITH CLIP-ON SYSTEM:

Flap mounting is simple and secure. Dismantling is also done without tools.



CONVENIENT ADJUSTMENT:

Accurate weight balancing of the front panel is achieved using simple access from the front. The same applies to achieve the optimum gap pattern via the three-dimensional adjustments.



FREE FLAP

FREE FLAP 1.7 / 3.15



- > Hinge-less stay flap fittings: The two models - Free flap 1.7 and 3.15 are designed for all of the most common cabinet height and flap weight combinations
- > Pleasant operating experience even with heavy flaps
- > Stylish and compact design makes the cabinet interiors easy to access, and allows the fitting to be used even in furniture with low depth (starting at only 109 mm)
- > For front panels made from wood, glass or with aluminium frame
- > Common mechanism to achieve Soft Close or Push-to Open motion
- > Adaptable E-Drive for an electrically operated comfort solution
- > Cover caps for Free Flap 3.15 are also suitable for installation with Free Flap 1.7 to provide a harmonious look in cabinet interiors
- > Extremely suitable for installation in combination with cornices
- > Easy, practical and time-saving installation process

Technical Specifications



- > Area of application: For stay flap front panels with or without handle (push-to-open)
- > Material: Fitting: Steel, Cover cap: Plastic
- > Finish/colour: Fitting: Nickel plated, Cover cap: Grey, white or anthracite
- > For cabinet height: 200–450 mm (1.7) / 350–650 mm (3.15)
- > Min. cabinet depth: 109 mm (1.7) / 132 mm (3.15)
- > Opening angle: 90° or 107° (In 1.7, opening angle of 90° can be achieved by adding an optional opening angle restraint; in 3.15 the angles are adjustable on the fitting)
- > Adjustment facility: Height/lateral/ tilting angle of front panel ± 1.5 mm, Weight balancing of front panel
- > Installation: Fitting: for screw fixing on pre-drilled side panel with pre-mounted Euro screws and built-in positioning pins, Front Panel: Tool-free assembly (clip system) onto pre-mounted screw-on brackets of the mechanism arms

Quick Fixing System

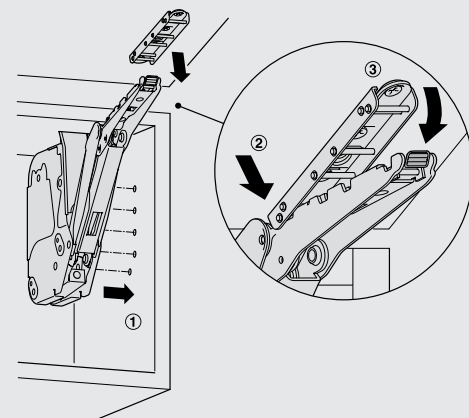

- ① Fit the lift mechanism in place onto the pre-drilled side panel with the help of the built-in positioning pins and tighten the pre-mounted Euro screws
- ②–③ Fit and engage the front panel onto the Free Flap arm

Ease of Adjustment

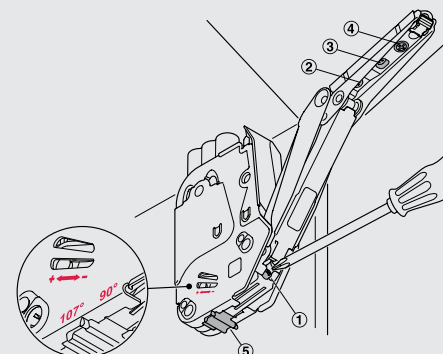

- ① Weight Balancing
- ②–④ Three dimensional adjustments to achieve optimum gap pattern – ② Height Adjustment: ± 1.5 mm ③ Lateral Adjustment: ± 1.5 mm ④ Tilt Adjustment: $\pm 1.5^\circ$
- ⑤ Built-in Opening Angle Stop (only for Free Flap 3.15)

FREE FLAP 1.7 / 3.15

Product Specification



FREE FLAP 3.15

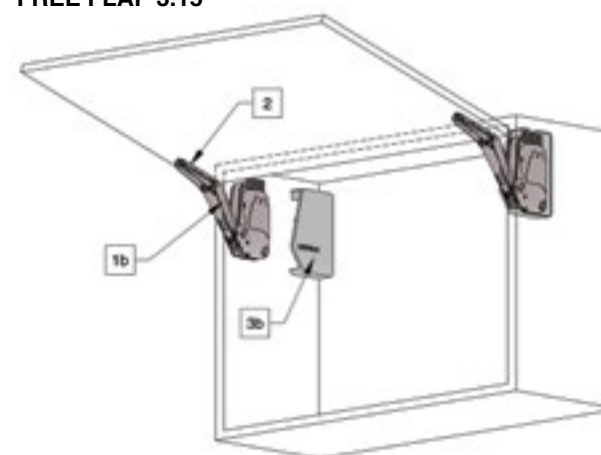

FREE FLAP 1.7

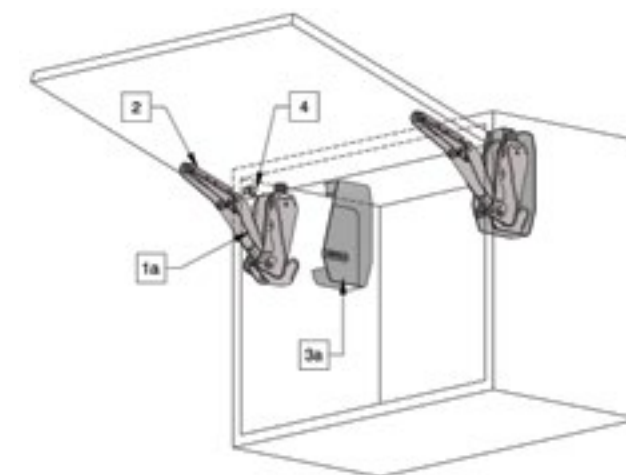

- 1a Free Flap 1.7 Lift System
- 2 Front Fixing Brackets
- 3a Cover Caps for Free Flap 1.7
- 4 Opening Angle Stop

- 1b Free Flap 3.15 Lift System
- 2 Front Fixing Brackets
- 3b Cover Caps for Free Flap 3.15

Mechanism Selection Table as Per Flap Weight (including handle)

Cabinet Height (in mm)	FREE FLAP 1.7			FREE FLAP 3.15			
	A	B	C	D	E	F	G
	Front Panel Weight (in Kg)						
200	1.7–4.6	3.6–7.9	6.8–14.7				
225	1.5–4.1	3.1–7.1	6.0–13.1				
250	1.3–3.8	2.9–6.4	5.4–11.8				
275	1.2–3.3	2.5–5.7	4.8–10.6				
300	1.1–3.1	2.4–5.1	4.4–9.6				
325	1.0–2.8	2.1–4.6	4.0–8.8				
350	0.9–2.6	2.0–4.2	3.7–8.1	5.2–11.0	6.7–14.3	10.1–21	13.5–27.3
375	0.9–2.3	1.9–3.8	3.5–7.5	4.9–10.2	6.3–13.1	9.4–19.8	12.5–25.2
400	0.8–2.1	1.7–3.6	3.2–7.0	4.7–9.6	5.9–12.4	8.9–18.6	11.8–23.3
425	0.7–1.9	1.5–3.4	2.9–6.5	4.4–9.0	5.6–11.6	8.3–17.4	11.0–21.8
450	0.6–1.7	1.4–3.2	2.7–6.1	4.1–8.4	5.2–10.9	7.8–16.3	10.4–20.5
475				3.9–8.0	4.9–10.3	7.4–15.4	9.8–19.3
500				3.7–7.5	4.7–9.7	7.0–14.6	9.2–18.3
525				3.5–7.1	4.4–9.2	6.6–13.9	8.8–17.3
550				3.3–6.8	4.2–8.8	6.3–13.2	8.3–16.5
575				3.2–6.5	4.0–8.4	6.0–12.5	8.0–15.6
600				3.0–6.2	3.8–8.0	5.7–12.0	7.6–15.0
625				2.8–5.9	3.6–7.6	5.4–11.5	7.2–14.4
650				2.6–5.6	3.4–7.3	5.3–11.0	6.9–14.0

FREE FLAP 1.7 / 3.15

Ordering Information

Standard Configuration Sets and Components



FREE FLAP 1.7 SETS*	
Model	Article No.
A	372.38.151
B	372.38.152
C	372.38.153

*Consist of: Free Flap 1.7 Lift Mechanism - Left and Right, 2 Front Fixing Brackets for Wooden Front Panels or Front Panels with Wide Aluminium Frame (Min. Frame Width: 45 mm) and Paper Template

FREE FLAP 3.15 SETS*	
Model	Article No.
D	372.38.154
E	372.38.155
F	372.38.156
G	372.38.157

*Consist of: Free Flap 3.15 Lift Mechanism - Left and Right, 2 Front Fixing Brackets for Wooden Front Panels or Front Panels with Wide Aluminium Frame (Min. Frame Width: 45 mm) and Paper Template



Cover Caps			
Free Flap System	Anthracite	Grey	White
1.7	372.38.158	372.38.159	372.38.160
3.5	372.38.161	372.38.162	372.38.163

Unit: 1 Pair

Note: Cover caps for Free Flap 3.15 are also suitable for installation with Free Flap 1.7



Narrow Aluminium Frame Adapters	
Finish	Article No.
Nickel-plated	372.91.599

Unit: 1 Pair

Note: Fitting is visible with float and satin frosted glass, passe-partout or obscure glass may therefore be used.

- > For flaps with 20 mm aluminium frame
- > M4 x 10 mm fixings included
- > Material: Zinc alloy



Opening Angle Stop	
Finish	Article No.
Black	372.91.499

Unit: 1 Pair

- > For limiting opening angle of 107° to 90°
- > Only applicable for Free Flap 1.7 sets

Individual Components



1: Free Flap 1.7 Lift System		
Model	Article No.	
	Left	Right
A	372.91.601	372.91.600
B	372.91.603	372.91.602
C	372.91.605	372.91.604

Unit: 1 Piece

Free Flap 3.15 Lift System		
Model	Article No.	
	Left	Right
D	372.91.262	372.91.261
E	372.91.264	372.91.263
F	372.91.266	372.91.265
G	372.91.258	372.91.257

Unit: 1 Piece

Front Fixing Brackets	
Fixing	Article No.
Screw-on	372.56.560

Unit: 1 Pair

FREE FLAP 1.7 / 3.15

Planning

Free Flap 1.7

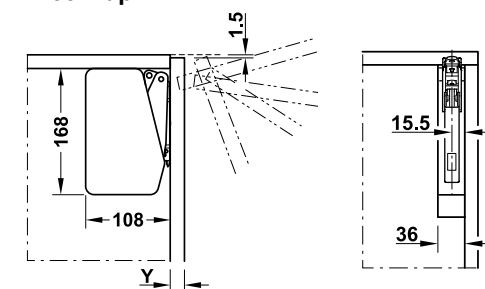

Free Flap 3.15

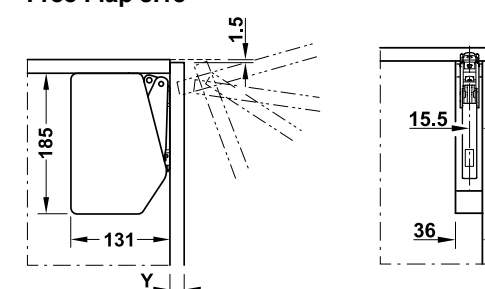

Space Requirement

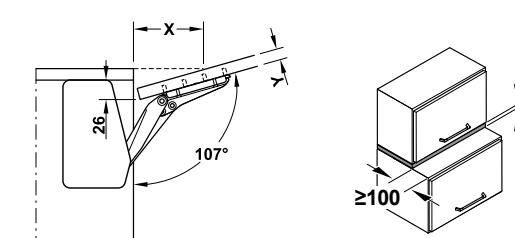

Front panel thickness Y mm	16	19	22	26	28
Distance X mm (with top panel thickness 16 mm)	83	74	64	52	46

Carcase Drilling Positions

Free Flap 1.7

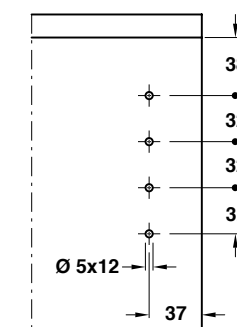

Free Flap 3.15

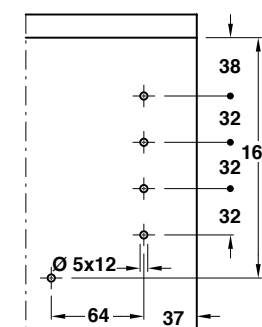

Front Panel Drilling Positions

Wooden / Wide Aluminium Framed Panel

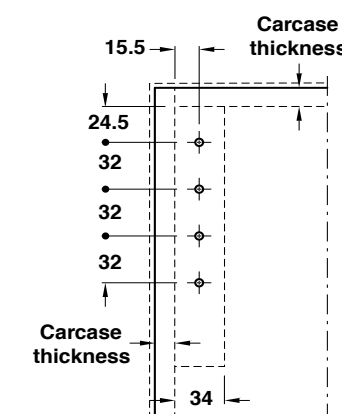

Narrow Aluminium Framed Panel

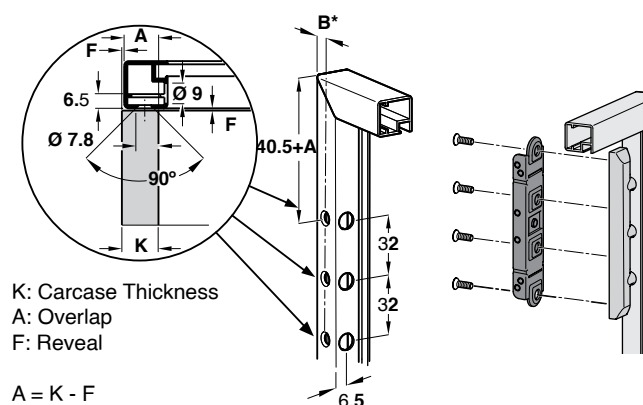

K: Carcase Thickness
A: Overlap
F: Reveal

A = K - F
B = A - 5.5 mm

B : 7 mm (minimum), 13.5 mm (maximum)



SCAN ME



SCAN ME

FREE FLAP 1.7 / 3.15 - PUSH-TO-OPEN ACCESSORIES

Push-to-Open Triggers and Housing



- > Area of application: For front panels without handle, with Free flap 1.7 and 3.15 stay flap fitting, up to a width of max.1,200 mm
- > Material: Plastic
- > Installation: For mounting in drilled hole Ø 10 mm or sliding into screw-on housing
- > Adjustment facility: Front gap +4 mm
- > Release distance approx. 2 mm

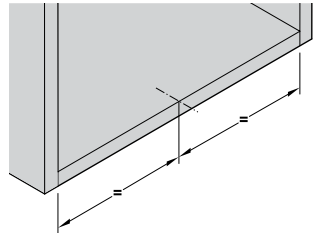

Positioning with 1 push-to-open trigger

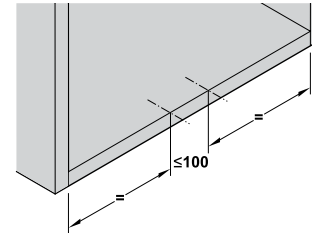

Positioning with 2 push-to-open triggers

Differentiation criteria of the model versions
Colour-coded housing underside for differentiation between models type 1 (green), type 2 (yellow) and type 3 (blue)



Push-to-Open Trigger Selection Table

Free Flap 1.7

Cabinet height (mm)	Push-to-Open Triggers (Model & Quantity)				
	Type 1 x 1	Type 2 x 1	Type 3 x 1	Type 2 x 2	Type 3 x 2
	Front Panel Weight in Kg				
200	1.7 - 3.1	3.1 - 5.4	5.4 - 8.3	8.3 - 12.3	12.3 - 14.7
225	1.5 - 2.9	2.9 - 4.7	4.7 - 7.1	7.1 - 11.6	11.6 - 13.1
250	1.3 - 3.1	3.1 - 5.1	5.1 - 6.9	6.9 - 10.5	10.5 - 11.8
275	1.2 - 3.3	3.0 - 5.0	5.0 - 6.8	6.8 - 10.0	10.0 - 10.6
300	1.1 - 3.0	2.7 - 4.6	4.6 - 6.6	6.6 - 9.6	
325	1.0 - 3.0	2.6 - 4.2	4.2 - 6.0	6.0 - 8.8	
350	0.9 - 2.9	2.4 - 4.2	3.9 - 5.9	5.9 - 8.1	
375	0.9 - 2.7	2.7 - 3.9	3.9 - 5.7	5.7 - 7.5	
400	0.8 - 2.7	2.7 - 3.8	3.8 - 5.6	5.6 - 7.0	
425	0.7 - 2.3	2.3 - 4.0	4.0 - 5.0	5.0 - 6.5	
450	0.6 - 2.4	2.4 - 3.3	3.3 - 5.1	5.1 - 6.1	

Free Flap 3.15

Cabinet height (mm)	Push-to-Open Triggers (Model & Quantity)				
	Type 1 x 1	Type 2 x 1	Type 3 x 1	Type 2 x 2	Type 3 x 2
	Front Panel Weight in Kg				
350		5.2-8.1	6.7-11.8	10.1-18.1	17.9-27.3
400		4.7-9.0	7.9-12.3	10.7-17.9	17.2-23.3
450	4.1-5.0	5.0-8.4	7.8-10.9	10.2-16.7	16.7-20.5
500	3.7-4.9	4.7-7.8	7.0-10.7	10.0-16.0	16.0-18.3
550	3.3-4.9	4.5-7.5	6.8-10.4	9.7-15.3	15.3-16.5
600	3.0-4.7	4.2-7.2	6.7-10.2	9.2-15.0	
650	2.6-4.1	3.4-6.4	5.3-10.5	8.4-14.0	

FREE FLAP 1.7 / 3.15 - PUSH-TO-OPEN ACCESSORIES

Ordering Information



- > For mounting in drilled hole Ø 10 x 90 mm
- > Material: Plastic with rubber buffer

Push-To-Open Triggers					
Model	Colour Code	Ejection Force	Anthracite	Grey	White
Type 1	Green	17 - 23 N	372.91.390	372.91.500	372.91.700
Type 2	Yellow	22 - 34 N	372.91.391	372.91.501	372.91.701
Type 3	Blue	26 - 48 N	372.91.392	372.91.502	372.91.702

Unit: 1 Piece

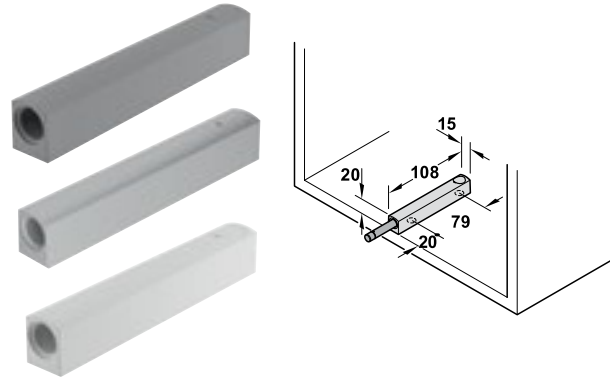

- > Recommended type of screw: Head Ø : 7-9 mm, Thread Ø 3.5-4.5 mm, Screw length >15 mm
- > Material: Plastic

Screw-On Housing	
Colour	Article No.
Anthracite	372.91.393
Grey	372.91.503
White	372.91.703

Unit: 1 Piece

FREE FLAP 1.7 / 3.15 - E-DRIVE

FREE FLAP 1.7 / 3.15 - E-DRIVE

> Free E-Drive is Häfele's electro-mechanical movement assistance for the entire application area of the Free family

> The electrical drive solution is perfectly coordinated with all Free Lift Systems

> Standard programming and operating functions for all Free E applications

> The installation position and the range of applications of the Free Flap fittings remain unchanged

> Component installation can be done practically without tools

> The E-Drive unit can be retrofitted at any time to the standard mechanical fitting

> Extremely quiet and smooth running

> With integrated free-swing function for effortless manual operation of the flap (even in the event of a power failure)

> Automatic safety stop function interrupts the opening or closing movement if obstacles are detected

> Parallel connection for up to three drive units, collision avoidance with cross-corner installations and temporary disabling of the drive to clean the flap fronts can also be programmed (optional)



> Area of application: Drive housing: Zinc alloy, Cover caps: Plastic

> Material: Fitting: Nickel plated, Cover cap: Grey, white or anthracite

> For flap width: <1,200 mm (>1,200 mm = 2 sets)

> Min. cabinet depth: 109 mm (1.7) / 132 mm (3.15)

> Input voltage: 100–240 V AC/50–60 Hz/1.3 A

> Nominal voltage: 24 V DC/3.75 A

> Output voltage: For interior cabinet lighting: 24 V DC/1.2 A

> Stand-by power consumption: 1 W

> Radio Frequency: 2.4 GHz

> Protection class: II

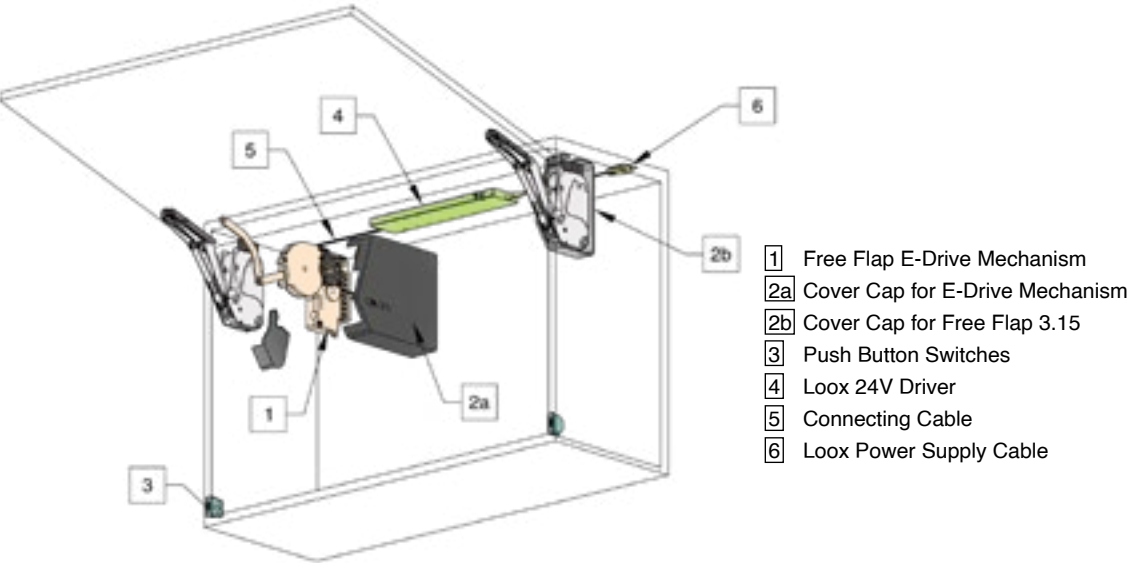

> Installation: E-Drive unit for screw fixing onto left Free fitting, Push button sender for recess installation in side panel (drill hole Ø 35 mm)

FREE FLAP 1.7/3.15



Ordering Information

Sets

E-Drive Set For Free Flap 1.7 / 3.15*			
For Models	Article Number		
A - G	372.38.165		



*Consists of: 1 Free Flap 1.7 / 3.15 E-Drive Unit, 1 Loox Driver: 90 W- 24V, 1 Loox Power Supply Cable and 1 Connection Cable

E-Drive Free Flap Cover Cap Set*			
Free Flap Systems	Anthracite	Grey	White
1.7 E / 3.15 E	372.38.186	372.38.185	372.38.184

*Consists of: 1 Cover Cap for E-Drive (left) and 1 Cover Cap for Free Flap 3.15 (right)

Unit: 1 Set

Individual Components

Free Flap E-Drive Mechanism Set*	
For Models	Article No.
A - G	372.91.099

*Consists of: Free Flap E-Drive Mechanism, 1 E-Drive Front Fixing Bracket and 2 E-Drive Push Button Switches

Unit: 1Set

E-Drive Push Button	
Finish	Article No.
Grey	372.91.097

Unit: 1 Pair

> Radio frequency: 2.4 GHz
> Replaceable CR 2032 button cell lithium battery included

LOOX 24 V Driver	
Wattage	Article No.
90 W	833.77.949

Unit: 1 Piece

> Only 1 E-drive unit can be connected to one driver
> Colour: Black
> With overload protection
> Degree of Protection: IP 20



LOOX Power Supply Cable		
Type of plug	Length	Article No.
EU	2000 mm	833.89.002

Unit: 1 Piece



Connecting Cable	
Length	Article No.
1400 mm	850.00.022

Unit: 1 Piece

Planning

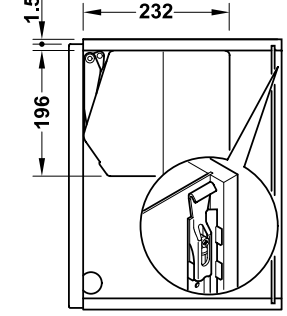

Space Requirement

Free Flap 1.7

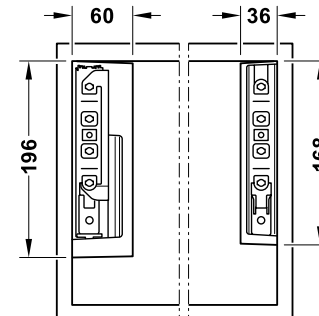

Free Flap 3.15

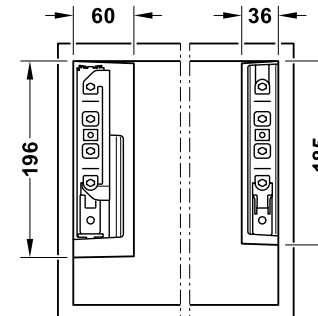

FREE FLAP 1.7 / 3.15 - E-DRIVE

Cable Guide and Push Button Switch Installation

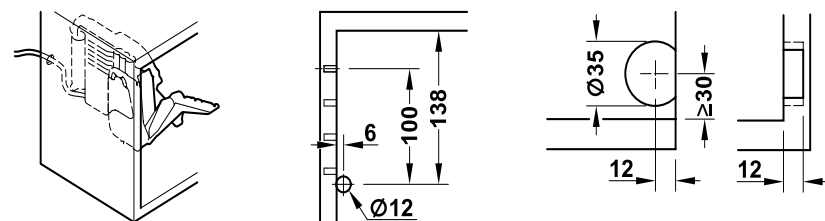

Installation and Programming

2



> The E-Drive drive unit sits on the left-hand fitting. The lead is simply inserted into the drive unit.



> 24 V interior cabinet lighting from the Loox product range can also be operated using the drive unit.
> The light switches on when the flap is opened.



> The push button sender assigning and the programming of other functions take place via a switching button directly on the drive unit. All programming processes are accompanied and acknowledged by visual and acoustic system feedback.

Operation



> Opening: The sensor switches, which are usually recessed in the side panels, react to gentle pressure on the flap front.
> They emit a radio signal and the flap moves quietly and automatically to the open position.



> Closing: Pressing the button on the inner surface of the sensor switch sends a radio signal to the drive, which then automatically closes the flap.
> The movement to the closed position takes place quietly and gently.



> The free-swing function integrated in all E-Drive drive units makes effortless manual operation of the flap applications possible.
> The multi-position stop function that is typical of the Free flap fittings ensures that the flap locks securely in any position.



SCAN ME





FREE FOLD

FREE FOLD

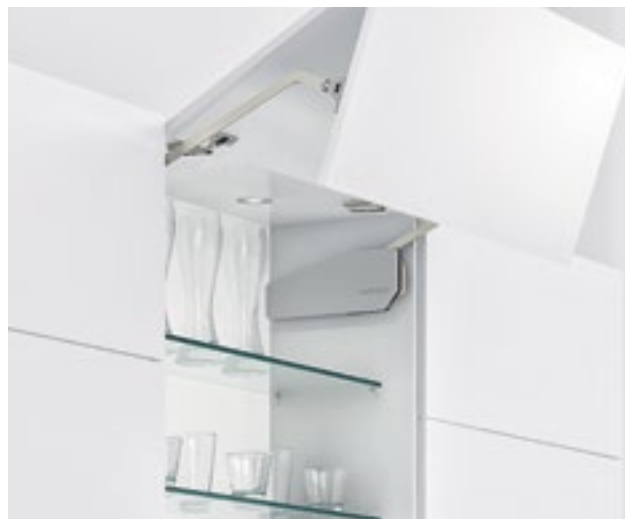

- > For two-piece flaps with division 1:1 made from wood or with aluminium frame
- > High front panels can be lifted up in a space-saving way
- > The handle is reachable at all times
- > Pleasant operating experience even with heavy flaps
- > Stylish and compact design
- > Flap front panel material combinations possible
- > Safety stop
- > Minimum opening resistance, multi-position stop function and integrated soft opening and soft closing mechanisms for ease and convenience
- > For use in combination with standard 110° concealed hinges
- > Adaptable E-Drive for an electrically operated comfort solution
- > Practical and quick installation

Highest Operating Convenience



- > Minimum opening resistance
- > Flap locks in any position (multi-position stop)
- > Smooth, soft closing movement

Adjustment facility

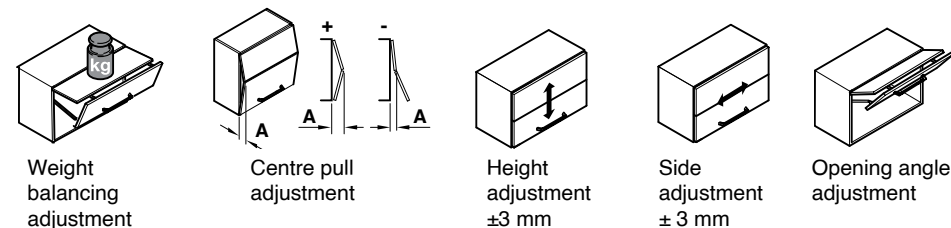

Technical Specifications

- > Material: Fitting: Steel, Cover cap: Plastic
- > Finish/colour: Fitting: Galvanised, Cover cap: Grey, white or anthracite
- > Max. cabinet height: 1040 mm
- > Min. cabinet depth: 288 mm
- > Max. cabinet width: 1800 mm (with 4 lift mechanisms)
- > Adjustment facility: Height/ side/ depth of top flap (via concealed hinge) and lower flap (via connecting hinge)
Weight balancing of panel /centre pull (via lift mechanism)
- > Installation: Fitting: for screw fixing on pre-drilled side panel with pre-mounted Euro screws and built-in positioning pins, Front Panel: Tool-free assembly (clip system) onto pre-mounted screw-on brackets of the mechanism arms

Quick Fixing System

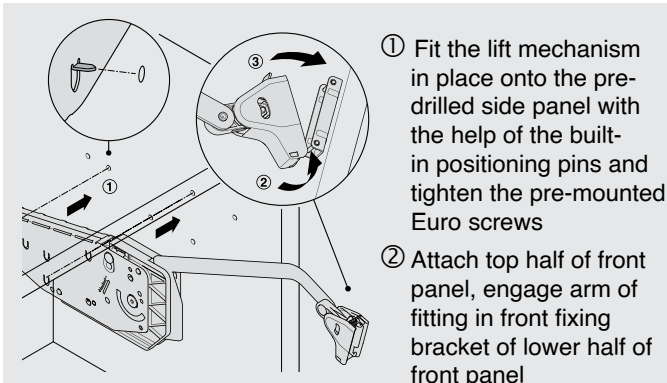

Weight Balancing Adjustment of Fitting

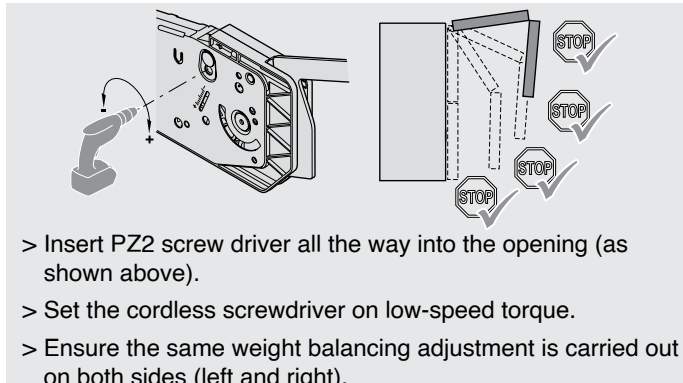

FREE FOLD

Product Specification

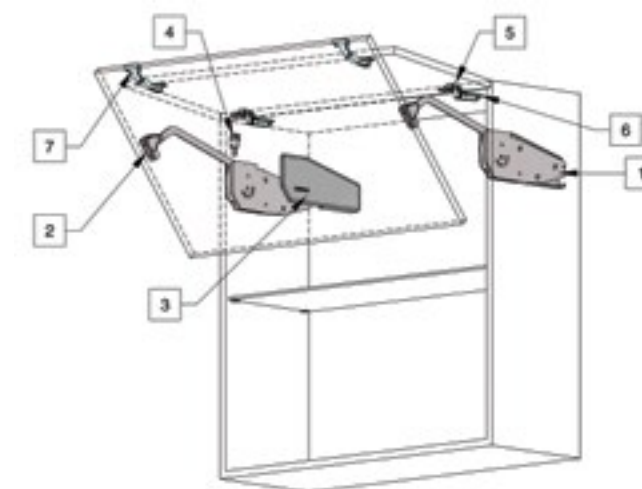

- 1 Free Fold Lift System
- 2 Front Fixing Brackets
- 3 Cover Caps
- 4 Opening Angle Stop
- 5 Duomatic 110° Concealed Hinge for Top Flap
- 6 Straight Mounting Plate for Duomatic Concealed Hinge
- 7 Connecting Hinge

Mechanism Selection Table and Ordering Information

Standard Configuration Sets & Components

Free Fold Sets*			
Model	Cabinet height (mm)	Flap weight (kg)	Article No.
C3fo	480-530	5.2-11.1	372.38.102
C4fo	480-530	7.8-16.3	372.38.103
C5fo	480-530	12.7-26.5	372.38.101
D3fo	520-590	4.8-10.3	372.38.105
D4fo	520-590	7.2-15.2	372.38.106
D5fo	520-590	11.8-24.5	372.38.104
E3fo	580-650	4.3-9.2	372.38.107
E4fo	580-650	6.5-13.5	372.38.108
F3fo	650-730	3.9-8.3	372.38.109
F4fo	650-730	5.8-12.2	372.38.110
G4fo	710-790	5.3-11.1	372.38.111
G5fo	710-790	8.7-18.0	372.38.112
H4fo	770-840	4.9-10.3	372.38.113
H5fo	770-840	8.0-16.7	372.38.114
I5fo	840-910	7.3-15.3	372.38.115
J5fo	910-970	6.8-14.2	372.38.116
K5fo	960-1010	6.5-13.5	372.38.117
K6fo	960-1010	8.6-17.3	372.38.118
L5fo	1000-1040	6.2-12.9	372.38.100

*Consist of: Free Fold Lift Mechanism - Left and Right, 2 Front Fixing Brackets for Wooden Front Panels or Front Panels with Wide Aluminium Frame (Min. Frame Width: 45 mm), 3 Connecting Hinges, 3 Metalla 510 110° Concealed Hinges, 3 Straight Clip Mounting Plates and Paper Template

FREE FOLD

Ordering Information



Hinge and Adapter Kit for Narrow Aluminium Profile*	
Article No.	
372.38.122	

*Consist of: 2 Narrow Aluminium Frame Adapters and 3 Narrow Aluminium Profile Hinges

Unit: 1 Set



Opening Angle Stop	
Finish	Article No.
Grey	372.37.060

Unit: 1 Piece

Individual Components



Free Fold		
Model	Article No.	
	Left	Right
L5fo	372.37.699	
C5fo	372.38.188	372.38.187
C3fo	372.37.612	
C4fo	372.37.613	
D5fo	372.38.194	372.38.193
D3fo	372.38.190	372.38.189
D4fo	372.38.192	372.38.191
E3fo	372.37.831	372.37.830
E4fo	372.37.833	372.37.832
F3fo	372.91.607	372.91.606
F4fo	372.91.609	372.91.608
G4fo	372.91.611	372.91.610
G5fo	372.37.853	372.37.852
H4fo	372.91.613	372.91.612
H5fo	372.91.615	372.91.614
I5fo	372.38.196	372.38.195
J5fo	372.37.684	
K5fo	372.37.694	
K6fo	372.37.691	

Unit: 1 Piece/ 1 Pair



Cover Caps			
Material	Anthracite	Grey	White
Plastic	372.38.119	372.38.120	372.38.121

Unit: 1 Pair

- > Restricts the opening angle to 90° for low level applications
- > Material: Plastic
- > 2 pieces required per flap fitting set



Front Fixing Brackets	
Fixing	Article No.
Screw-on	372.38.200

Unit: 1 Pair

- > For front panel made from wood or with wide aluminium frame



Metalla 510 - 110° Concealed Hinge For Top Flap	
Fixing	Article No.
Screw-on	329.17.600

Unit: 1 Piece

Straight Mounting Plate	
Fixing	Article No.
Clip	329.67.043

Unit: 1 Piece

- > Material: Steel/ Zamac
- > Finish: Nickel plated
- > Adjustment facility: Side adjustment from -1.5 to +4.5 mm (via Hinge), Depth Adjustment from -0.5 mm to 2.8 mm (via Mounting Plate) Height Adjustment : 2 mm (via Mounting Plate)
- > With automatic closing spring
- > Mounting: Screw Mounting

FREE FOLD

Ordering Information



Narrow Aluminium Frame Adapters	
Finish	Article No.
Nickel-plated	372.37.044

Unit: 1 Pair

Note

Fitting is visible with float and satin frosted glass, passe-partout or obscure glass may therefore be used.

- > For flaps with 20 mm aluminium frame
- > Material: Zinc alloy
- > Fixing material supplied



Connecting Hinge	
Fixing	Article No.
Screw-on	372.64.796

Unit: 1 Piece

- > Area of application: For wooden flaps and flaps with aluminium frame, from frame width 20 mm
- > Material: Zinc alloy
- > Finish: Nickel plated
- > Adjustment facility: 3-dimensional, side adjustment ± 2 mm, gap adjustment -2 to +1 mm, depth adjustment ± 1.5 mm
- > With **finger protection system**: The hinge comes apart when fingers get trapped unintentionally in the gap of the flap.

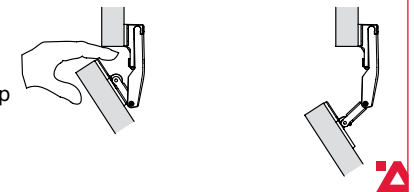

Planning and Space Requirement

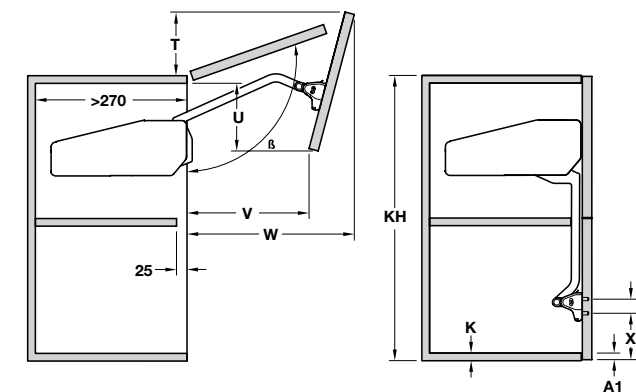

- β : Opening angle
- KH: Cabinet height
- K: Panel thickness
- T: Space required on top of the cabinet
- W: Space required in front of the cabinet
- X: Drilling distance for screw hole for front fixing brackets from lower edge of front panel

KH	β (°)	Q	R (mm)	S (mm)	T (mm)	U (mm)	V (mm)	W (mm)
480-530	~107-96	1.1	426	328	100-37	100-155	203-186	328-370
520-590	~107-93	1.1	466	347	106-23	112-184	213-190	347-401
580-650	~108-95	1.2	589	377	119-40	126-197	227-207	375-430
650-730	~107-94	1.2	664	409	124-38	147-224	238-215	411-470
710-790	~108-95	1.2	736	439	136-46	161-233	250-219	439-500
770-840	~108-95	1.0	644	467	146-43	179-223	267-200	466-527
840-910	~108-98	1.2	882	501	154-70	195-248	272-231	502-559
910-970	~107-98	1.1	865	533	160-78	214-246	282-225	536-588
960-1010	~107-100	1.1	915	557	170-99	228-251	295-240	560-605
1000-1040	~107-102	1.1	954	576	177-120	239-256	306-256	578-616

FREE FOLD

Carcase Drilling Positions

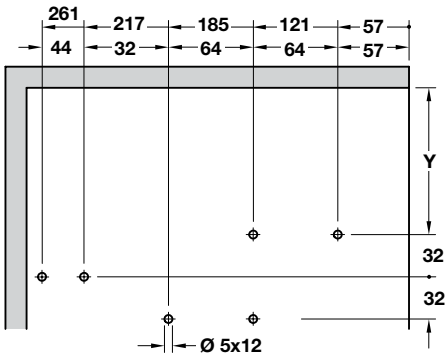

Metalla 510 - Concealed Hinge & Mounting Plate Drilling Pattern

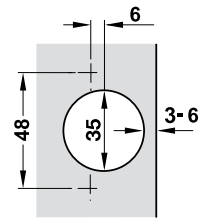

Door overlay mm											
9	10	11	12	13	14	15	16	17	18	19	20
						3	4	5	6		
Distance to cup E mm						Mounting plate distance mm					
											3

Front Panel Drilling Positions

Wooden / Wide Aluminium Framed Panel

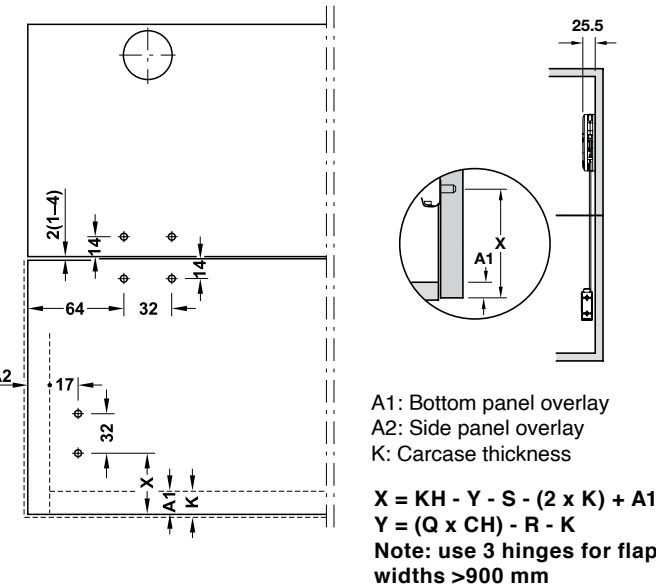

Connecting Hinge Drilling Pattern & Adjustment

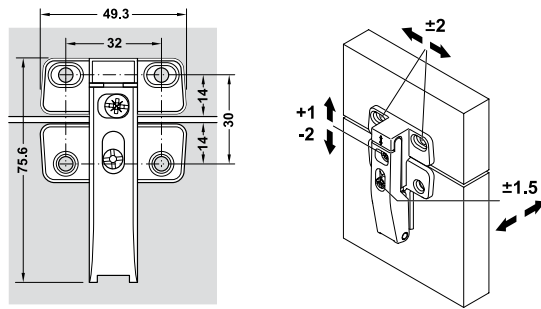

Positioning of Opening Angle Stop

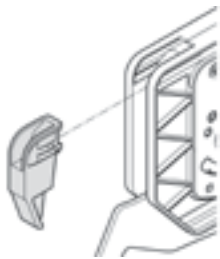

Narrow Aluminium Framed Panel

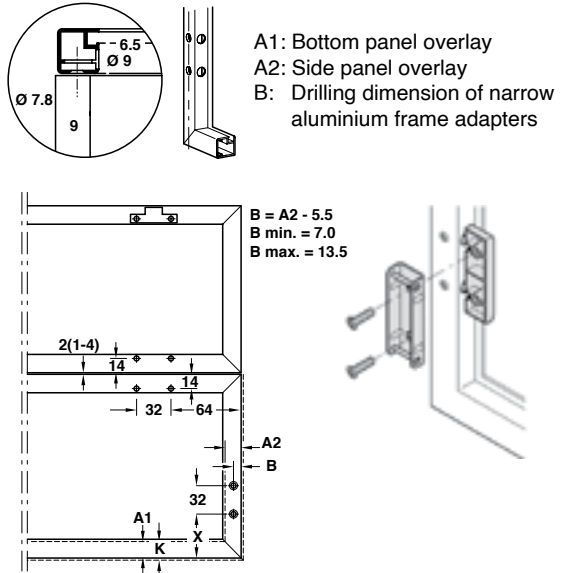

Metalla 510 - Narrow Aluminium Profile Hinge & Mounting Plate Drilling Pattern

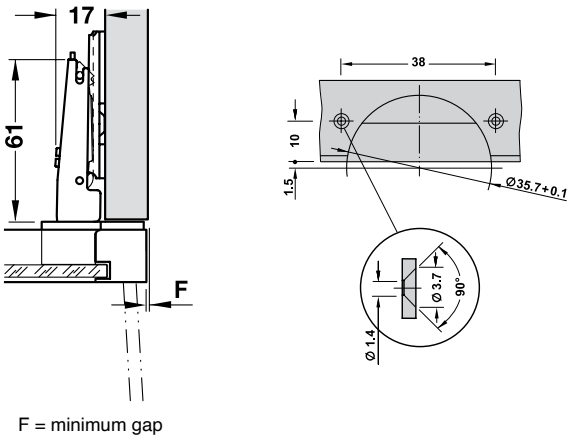

SCAN ME

FREE FOLD - E-DRIVE

- > Free E-Drive is Häfele's electro-mechanical movement assistance for the entire application area of the Free flap fitting family
- > The electrical drive solution is perfectly coordinated with all Free Lift Systems
- > Standard programming and operating functions for all Free E applications
- > The installation position and the range of applications of the Free Fold fittings remain unchanged
- > Component installation can be done practically without tools
- > The E-Drive unit can be retrofitted at any time to the standard mechanical fitting
- > Extremely quiet and smooth running
- > With integrated free-swing function for effortless manual operation of the flap (even in the event of a power failure)
- > Automatic safety stop function interrupts the opening or closing movement if obstacles are detected
- > Parallel connection for up to three drive units, collision avoidance with cross-corner installations and temporary disabling of the drive to clean the flap fronts can also be programmed (optional)



- > Material: Drive housing: Zinc alloy, Cover caps: Plastic
- > Finish/colour: Fitting: Nickel plated, Cover cap: Grey, white or anthracite
- > For flap width: <1,200 mm (>1,200 mm = 2 sets)
- > For cabinet height: 480 –1040 mm
- > Input voltage: 100–240 V AC/50–60 Hz/1.3 A
- > Nominal voltage: 24 V DC/3.75 A
- > Output voltage: For interior cabinet lighting: 24 V DC/1.2 A
- > Stand-by power consumption: 1 W
- > Radio Frequency: 2.4 GHz
- > Protection class: II
- > Installation: E-Drive unit for screw fixing onto left Free fitting, Push button sender for recess installation in side panel (drill hole Ø 35 mm)

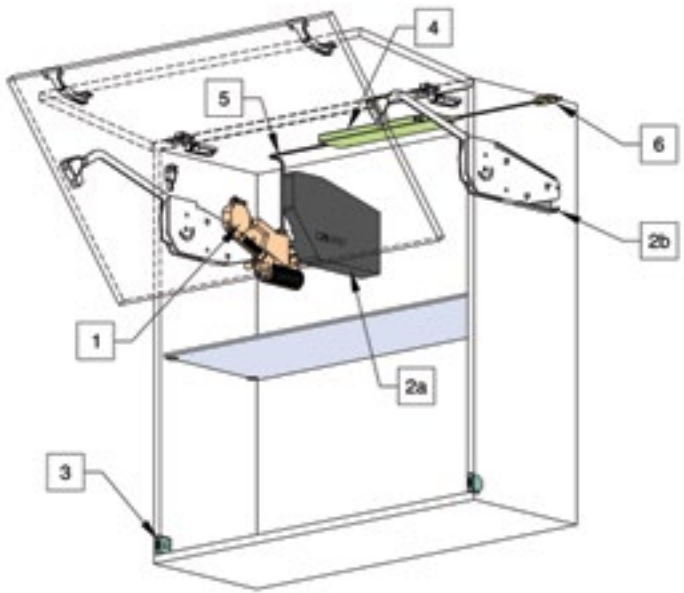

- 1 Free Fold E-Drive Mechanism
- 2a Cover Cap for E-Drive Mechanism
- 2b Cover Cap for Standard Mechanism
- 3 Push Button Switches
- 4 Loox 24V Driver
- 5 Connecting Cable
- 6 Loox Power Supply Cable

FREE FOLD - E-DRIVE

Ordering Information

Sets



E-Drive Set For Free Fold*	
For Models	Article No.
Applicable for all Free Fold models	372.38.164
*Consists of: 1 E-Drive Unit, 2 E-Drive Push Button Switches, 1 Loox Driver: 90 W -24V, 1 Loox Power Supply Cable and 1 Connection Cable	

Unit: 1 Set



E-Drive Free Fold Cover Cap Set*		
Anthracite	Grey	White
372.38.168	372.38.167	372.38.166
*Consists of: 1 Cover Cap for E-Drive (left) and 1 Cover Cap for Standard Fitting (right)		

Unit: 1 Set

Individual Components



Free Fold E-Drive Mechanism Set*	
For Models	Article No.
A - G	372.37.099
*Consists of: Free Fold E-Drive Mechanism and 2 E-Drive Push Button Switches	

Unit: 1 Set



E-Drive Push Button Switches	
Finish	Article No.
Grey	372.91.097

Unit: 1 Pair



LOOX 24 V Driver	
Wattage	Article No.
90 W	833.77.949

Unit: 1 Piece

> Radio frequency: 2.4 GHz
> Replaceable CR 2032 button cell lithium battery included

> Only 1 E-Drive unit can be connected to one driver
> Colour: Black
> With overload protection
> Degree of Protection: IP 20



LOOX Power Supply Cable		
Type of plug	Length	Article No.
EU	2000 mm	833.89.002

Unit: 1 Piece



Connecting Cable	
Length	Article No.
1400 mm	850.00.022

Unit: 1 Piece

Planning and Space Requirement

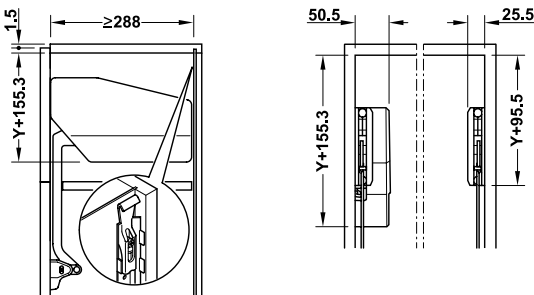

Cable Guide and Push Button Switch Installation

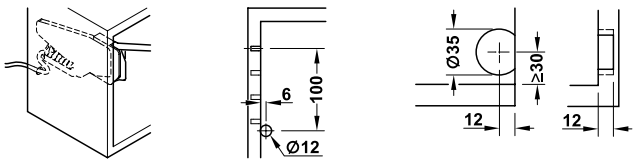

FREE FOLD - E-DRIVE

Installation and Programming



> The E-Drive drive unit sits on the left-hand fitting. The lead is simply inserted into the drive unit.



> 24 V interior cabinet lighting from the Loox product range can also be operated using the drive unit.
> The light switches on when the flap is opened.



> The push button sender assigning and the programming of other functions take place via a switching button directly on the drive unit. All programming processes are accompanied and acknowledged by visual and acoustic system feedback.

Operation



> Opening: The sensor switches, which are usually recessed in the side panels, react to gentle pressure on the flap front.
> They emit a radio signal and the flap moves quietly and automatically to the open position.



> Closing: Pressing the button on the inner surface of the sensor switch sends a radio signal to the drive, which then automatically closes the flap.
> The movement to the closed position takes place quietly and gently.



> The free-swing function integrated in all E-Drive drive units makes effortless manual operation of the flap applications possible.
> The multi-position stop function that is typical of the Free flap fittings ensures that the flap locks securely in any position.



SCAN ME



FREE SWING

FREE SWING



- > For one-piece flaps made from wood or with aluminium frame
- > Ideal for large flaps
- > Swivels around cornice profiles and surface mounted lights
- > Full access to the cabinet contents
- > Stylish and compact design
- > Minimum opening resistance, multi-position stop function and integrated soft opening and soft closing mechanisms for extremely pleasant operating feeling
- > Adaptable E-Drive for an electrically operated comfort solution

Highest Operating Convenience



- > Minimum opening resistance
- > Flap locks in any position (multi-position stop)
- > Smooth, soft closing movement

Quick Fixing System

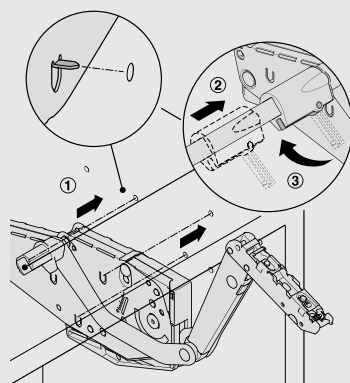

- 1 Fit the lift mechanism in place onto the pre-drilled side panel with the help of the built-in positioning pins and tighten the pre-mounted euro screws
- 2-3 Insert cross bar and secure it with cross bar connectors
- 4 Fit and engage the front panel onto the Free Swing mechanism arms

Technical Specifications

- > Material: Fitting: Plastic, steel, Cover cap: Plastic
- > Finish/colour: Fitting: Nickel plated, Cover cap: Grey, white or anthracite
- > Maximum cabinet height: 800 mm
- > Minimum cabinet depth: 273 mm
- > Maximum cabinet width: 1800 mm (with 4 mechanisms)
- > Adjustment facility: Height adjustment ± 1.5 mm, side adjustment ± 1.5 mm, tilting angle $\pm 1.5^\circ$, Weight balancing adjustment
- > Installation: Fitting: for screw fixing on pre-drilled side panel with pre-mounted Euro screws and built-in positioning pins, Front Panel: Tool-free assembly (clip system) onto pre-mounted screw-on brackets of the mechanism arms

Weight Balancing Adjustment of Fitting

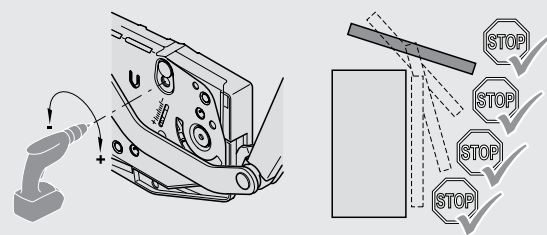

- > Insert PZ2 screwdriver all the way into the opening.
- > Set the cordless screwdriver on low speed torque.
- > Ensure the same weight balancing adjustment is done on both sides (left and right).

FREE SWING

Product Specification

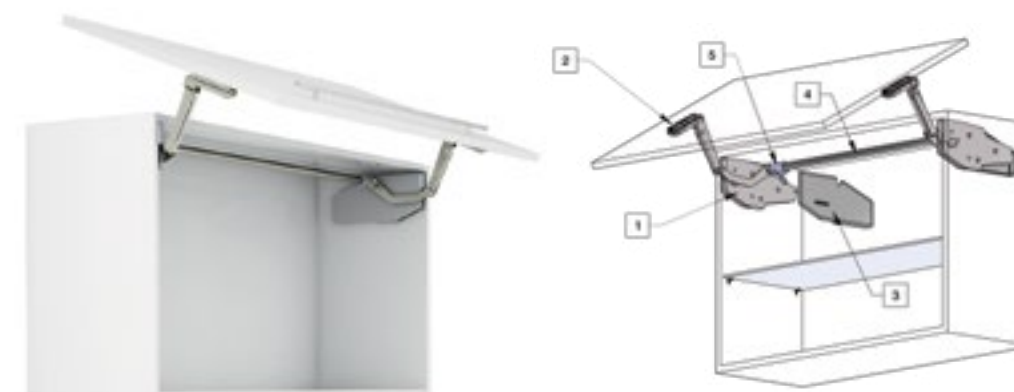

- 1 Free Swing Lift System
- 2 Front Fixing Brackets
- 3 Cover Caps
- 4 Cross Stabilisation Bar
- 5 Cross Bar Connectors

Mechanism Selection Table & Ordering Information

Standard Configuration Sets & Components

Free Swing Sets*			
Model	Cabinet Height(mm)	Flap Weight(in kg)	Article No.
S1Sw	370-500	1.8-4	372.38.139
S2sw	500-670	2.5-5.9	372.38.142
S3sw	670-800	2.9-6.5	372.38.143
S4sw	370-500	3-6.5	372.38.140
S5sw	500-670	4.5-10	372.38.146
S6sw	670-800	5.3-11.3	372.38.144
S7sw	370-500	4.5-10.3	372.38.141
S8sw	500-670	7-15.9	372.38.147
S9sw	670-800	8-17.1	372.38.145

*Consist of: Free Swing Lift Mechanism - Left and Right, 2 Front Fixing Brackets for Wooden Front Panels or Front Panels with Wide Aluminium Frame (Min. Frame Width: 45 mm), 2 Cross Bar Connectors and Paper Template



Cover Caps			
Material	Anthracite	Grey	White
Plastic	372.38.148	372.38.149	372.38.150

Unit: 1 Pair



Narrow Aluminium Frame Adapters	
Finish	Article No.
Nickel plated	372.91.599

Unit: Pair

Note
Fitting is visible with float and satin frosted glass, passe-partout or obscure glass may therefore be used.

- > Area of application: For connecting narrow aluminium frames to front fixing brackets
- > For flaps with 20 mm aluminium frame
- > Material: Zinc alloy
- > Fixing material supplied
- > Mounting: For left or right hand use



Cross Bar		
Cabinet Width	Length	Article No
600 mm	474 mm	372.38.134
1200 mm	1074 mm	372.38.138

Unit: 1 Piece

- > Area of application: For synchronising both fitting parts
- > Material: Aluminium
- > Finish: Silver coloured anodized
- > Can be cut to size
- > Cutting dimension = internal cabinet width – 88 mm
- > Side panel thickness W: 16/19 mm

FREE SWING

Ordering Information

Individual Components



Model	Cabinet Height (mm)	Flap Weight (kg)	Left	Right
S1sw	370-500	1.8-4	372.34.600	
S2sw	500-670	2.5-5.9	372.34.610	
S3sw	670-800	2.9-6.5	372.34.620	
S4sw	370-500	3-6.5	372.34.601	
S5sw	500-670	4.5-10	372.38.213	372.38.212
S6sw	670-800	5.3-11.3	372.34.621	
S7sw	370-500	4.5-10.3	372.34.602	
S8sw	500-670	7-15.9	372.38.215	372.38.214
S9sw	670-800	8-17.1	372.34.622	

Unit: 1 Piece / Pair

Front Fixing Brackets	
Fixing	Article No.
Screw-on	372.56.560

Unit: 1 Pair



Cross Bar Connector	
Colour	Article No
Light Grey	372.38.218

Unit: 1 Piece

Planning and Space Requirement

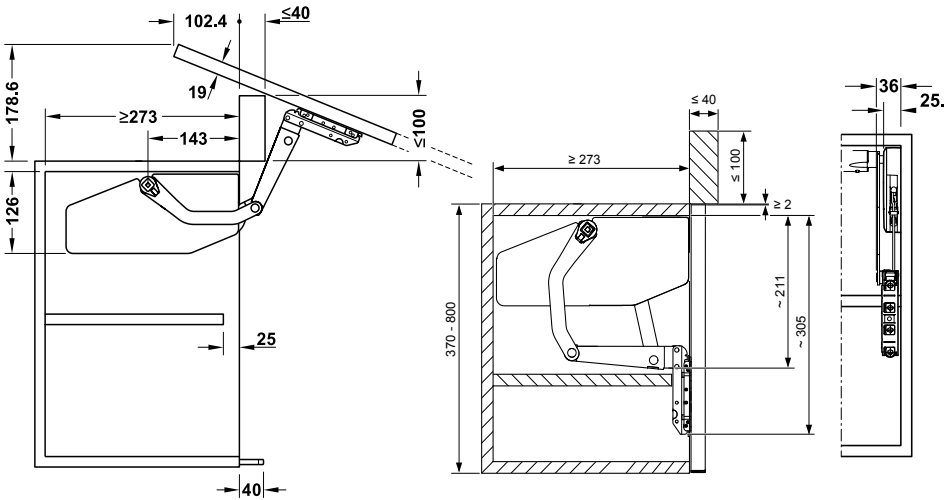

FREE SWING

Carcase Drilling Positions

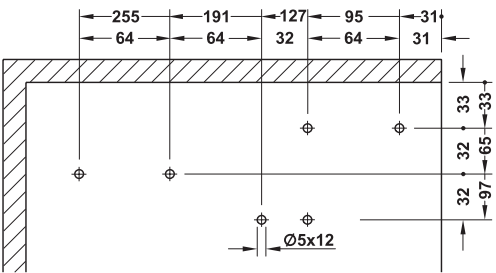

Cross Bar Installation

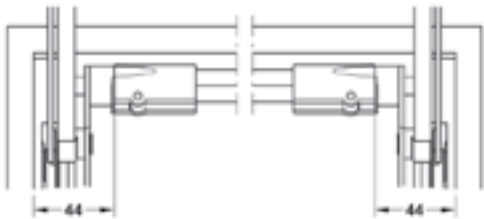

Cutting dimension = internal cabinet width – 88 mm

Front Panel Drilling Positions

Wooden / Wide Aluminium Framed Panel

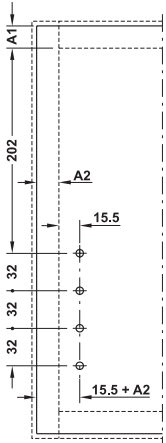

Narrow Aluminium Framed Panel

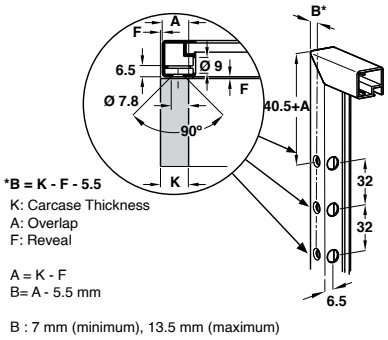

Installation

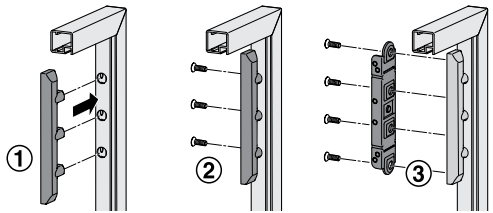

SCAN ME

FREE SWING - E-DRIVE

- > **Free E-Drive is Häfele's electro-mechanical movement assistance for the entire application area of the Free flap fitting family**
- > The electrical drive solution is perfectly coordinated with all Free Lift Systems
- > Standard programming and operating functions for all Free E applications
- > The installation position and the range of applications of the Free Swing fittings remain unchanged
- > Component installation can be done practically without tools
- > The E-Drive unit can be retrofitted at any time to the standard mechanical fitting
- > Extremely quiet and smooth running
- > With integrated free-swing function for effortless manual operation of the flap (even in the event of a power failure)
- > Automatic safety stop function interrupts the opening or closing movement if obstacles are detected
- > Parallel connection for up to three drive units, collision avoidance with cross-corner installations and temporary disabling of the drive to clean the flap fronts can also be programmed (optional)



- > Material: Fitting: Steel, Cover cap: Plastic, Drive housing: Zinc alloy
- > Finish/colour: Fitting: Nickel plated, Cover caps: Grey, white or anthracite
- > For cabinet height: 370–800 mm
- > For flap width: <1,200 mm (>1,200 mm = 2 sets)
- > Input voltage: 100–240 V AC/50–60 Hz/1.3 A
- > Nominal voltage: 24 V DC/3.75 A
- > Output voltage: For interior cabinet lighting: 24 V DC/1.2 A
- > Stand-by power consumption: 1 W
- > Radio frequency: 2.4 GHz
- > Protection class: II
- > Installation: E-Drive unit for screw fixing onto left Free fitting, Push button sender for recess installation in side panel (drill hole Ø 35 mm)

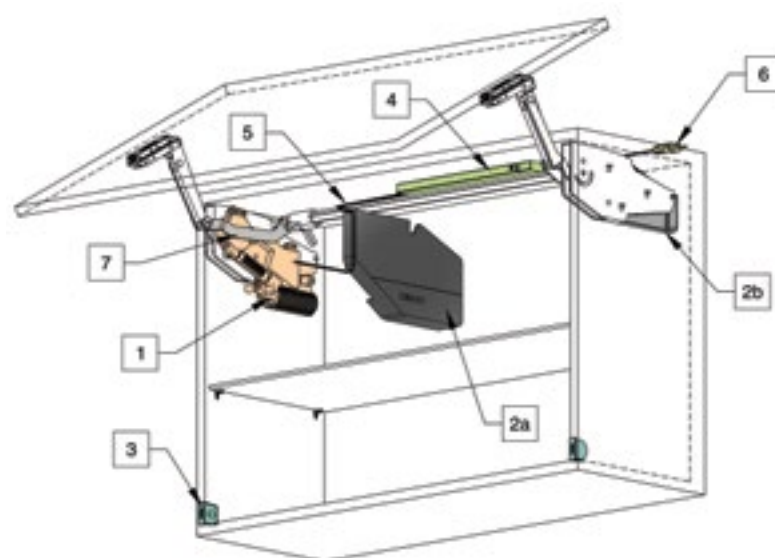

- 1 Free Swing E-Drive Mechanism
- 2a Cover Cap for E-Drive Mechanism
- 2b Cover Cap for Standard Mechanism
- 3 Push Button Switches
- 4 Loox 24V Driver
- 5 Connecting Cable
- 6 Loox Power Supply Cable
- 7 Free Swing E Drive Lever Arm

FREE SWING - E-DRIVE

Ordering Information

Sets



E-Drive Set For Free Swing*	
For Models	Article No.
Applicable for all Free Swing models	372.38.164
*Consists of: 1 E-Drive Unit, 2 E-Drive Push Button Switches, 1 Loox Driver: 90 W – 24V, 1 Loox Power Supply Cable and 1 Connection Cable	



Free Swing E Drive Cover Cap Set*		
Anthracite	White	Grey
372.38.168	372.38.169	372.38.170
*Consists of: 1 Cover Cap for E-drive (left), 1 Cover Cap for Standard Fitting (right) and 1 E-Drive Lever Arm		

Unit: 1 Set

Individual Components



E Drive Free Swing Cover Cap Set*		
Anthracite	White	Grey
372.37.085	372.34.085	372.34.080
*Consists of: 1 Cover Cap for E-drive (left) and 1 Cover Cap for Standard Fitting (right)		

Unit: 1 Pair



Free Swing E Drive Lever Arm	
Article No.	
372.34.090	

Unit: 1 Piece



Free Swing E-Drive Mechanism Set*	
For Models	Article No.
All Free Swing models	372.37.099
*Consists of: Free Swing E-Drive Mechanism and 2 E-Drive Push Button Switches	

Unit: 1 Set

E-Drive Push Button Switches	
Finish	Article No.
Grey	372.91.097

Unit: 1 Pair

- > Radio frequency: 2.4 GHz
- > Replaceable CR 2032 button cell lithium battery included

LOOX 24 V Driver	
Wattage	Article No.
90 W	833.77.949

Unit: 1 Piece

- > Only 1 E-drive unit can be connected to one driver
- > Colour: Black
- > With overload protection
- > Degree of Protection: IP 20



LOOX Power Supply Cable		
Type of plug	Length	Article No.
EU	2000 mm	833.89.002

Unit: 1 Piece



Connecting Cable	
Length	Article No.
1400 mm	850.00.022

Unit: 1 Piece

FREE SWING - E-DRIVE

Planning and Space Requirement

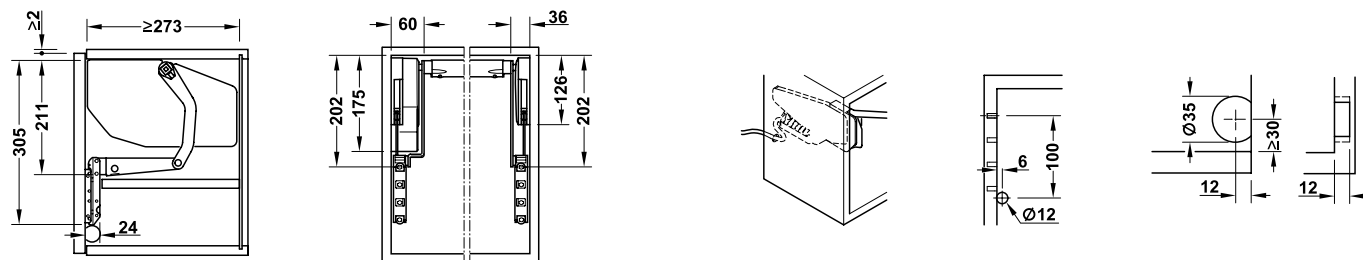

Cable Guide and Push Button Switch Installation

Installation and Programming

2



- > The E-Drive drive unit sits on the left-hand fitting. The lead is simply inserted into the drive unit.
- > 24 V interior cabinet lighting from the Loox product range can also be operated using the drive unit.
- > The light switches on when the flap is opened.
- > The push button sender assigning and the programming of other functions take place via a switching button directly on the drive unit. All programming processes are accompanied and acknowledged by visual and acoustic system feedback.

Operation



- > Opening: The sensor switches, which are usually recessed in the side panels, react to gentle pressure on the flap front.
- > They emit a radio signal and the flap moves quietly and automatically to the open position.
- > Closing: Pressing the button on the inner surface of the sensor switch sends a radio signal to the drive, which then automatically closes the flap.
- > The movement to the closed position takes place quietly and gently.
- > The free-swing function integrated in all E-Drive drive units makes effortless manual operation of the flap applications possible.
- > The multi-position stop function that is typical of the Free flap fittings ensures that the flap locks securely in any position.



SCAN ME





FREE UP

FREE UP



Highest Operating Convenience



- > Minimum opening resistance
- > Flap locks in any position (multi-position stop)
- > Smooth, soft closing movement

Quick Fixing System

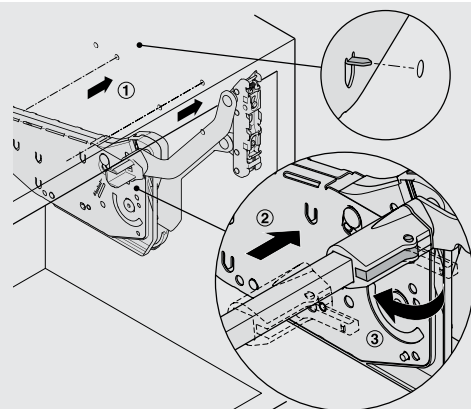

- ① Fit the lift mechanism in place onto the pre-drilled side panel with the help of the built-in positioning pins and tighten the pre-mounted euro screws
- ②-③ Insert cross bar and secure it with the cross bar connectors
- ④ Fit and engage the front panel onto the Free Up mechanism arms

- > For one-piece flaps made from wood or with aluminium frame
- > Can be used in combination with upper-mounted cabinets or front panels
- > Creates practical "niches" in tall cabinets, e.g. for electrical equipment
- > Cabinet contents are extremely easy to access
- > Excellent side stability
- > Minimum opening resistance, multi-position stop function and integrated soft opening and soft closing mechanisms for extremely pleasant operating feeling
- > Adaptable E-Drive for an electrically operated comfort solution
- > Stylish and compact design

Technical Specifications

- > Material: Fitting: Plastic, steel, Cover cap: Plastic
- > Finish/colour: Fitting: Nickel plated, Cover cap: Grey, white or anthracite
- > Maximum cabinet height: 600 mm
- > Minimum cabinet depth: 277 mm
- > Maximum cabinet width: 1800 mm (with 4 mechanisms)
- > Adjustment facility: Height adjustment ± 1.5 mm, side adjustment ± 1.5 mm, tilting angle $\pm 1.5^\circ$, weight balancing adjustment facility
- > Installation: Fitting: for screw fixing on pre-drilled side panel with pre-mounted Euro screws and built-in positioning pins, Front Panel: Tool-free assembly (clip system) onto pre-mounted screw-on brackets of the mechanism arms

Weight Balancing Adjustment of Fitting

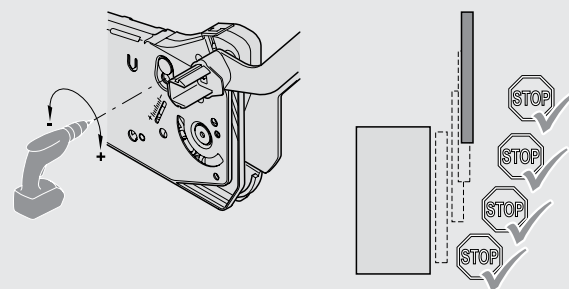

- > Insert PZ2 screwdriver all the way into the opening.
- > Set the cordless screwdriver on low speed torque.
- > Ensure the same weight balancing adjustment is carried out on both sides (left and right).

FREE UP

Product Specification

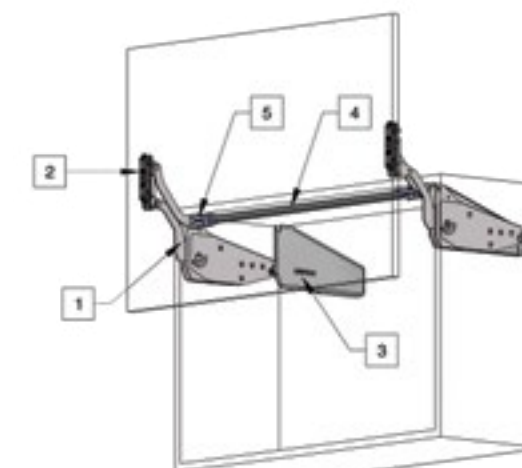

- 1 Free Up Lift System
- 2 Front Fixing Brackets
- 3 Cover Caps
- 4 Cross Stabilisation Bar
- 5 Cross Bar Connectors

Mechanism Selection Table & Ordering Information

Standard Configuration Sets & Components

Free Up Sets*			
Model	Cabinet Height(mm)	Flap Weight(in kg)	Article No.
P1us	345-420	2.4-4.8	372.38.123
P2us	345-420	4.1-8	372.38.124
P3us	345-420	7.4-14	372.38.127
Q1us	380-500	2.0-3.8	372.38.125
Q2us	380-500	3.4-6.7	372.38.126
Q3us	380-500	6.3-11.8	372.38.128
Q4us	380-500	9.3-17.4	372.38.129
R1us	430-600	1.6-3.3	372.38.130
R2us	430-600	2.6-5.5	372.38.131
R3us	430-600	5.0-9.7	372.38.132
R4us	430-600	7.4-14.6	372.38.133

Consists of: Free Up Lift Mechanism - Left and Right, 2 Front Fixing Brackets for Wooden Front Panels or Front Panels with Wide Aluminium Frame (Min. Frame Width: 45 mm), 2 Cross Bar Connectors and Paper Template



Cover Caps			
Material	Anthracite	Grey	White
Plastic	372.38.135	372.38.136	372.38.137

Unit: 1 Pair



Narrow Aluminium Frame Adapters	
Finish	Article No.
Nickel plated	372.91.599

Unit: Pair

Note

Fitting is visible with float and satin frosted glass, passe-partout or obscure glass may therefore be used.

- > Area of application: For connecting narrow aluminium frames to front fixing brackets
- > For flaps with 20 mm aluminium frame
- > Material: Zinc alloy
- > Fixing material supplied
- > Mounting: For left or right hand use

Cross Bar		
Cabinet Width	Length	Article No.
600 mm	474 mm	372.38.134
1200 mm	1074 mm	372.38.138

Unit: 1 Piece

- > Area of application: For synchronising both fitting parts
- > Material: Aluminium
- > Finish: Silver coloured anodized
- > Can be cut to size
- > Cutting dimension = internal cabinet width - 88 mm
- > Side panel thickness W: 16/19 mm

FREE UP

Ordering information

Individual Components



Model	Cabinet Height(mm)	Flap Weight(in kg)	Left	Right
P1us	345-420	2.4-4.8	372.33.610	
P2us	345-420	4.1-8	372.33.611	
P3us	345-420	7.4-14	372.33.612	
Q1us	380-500	2.0-3.8	372.33.620	
Q2us	380-500	3.4-6.7	372.33.621	
Q3us	380-500	6.3-11.8	372.38.202	372.38.201
Q4us	380-500	9.3-17.4	372.38.204	372.38.203
R1us	430-600	1.6-3.3	372.33.630	
R2us	430-600	2.6-5.5	372.33.631	
R3us	430-600	5.0-9.7	372.38.206	372.38.205
R4us	430-600	7.4-14.6	372.38.208	372.38.207

Unit: 1 Piece / Pair

Front Fixing Brackets	
Fixing	Article No.
Screw-on	372.56.560

Unit: 1 Pair



Cross Bar Connector	
Colour	Article No
Light Grey	372.38.218

Unit: 1 Piece

Planning and Space Requirement

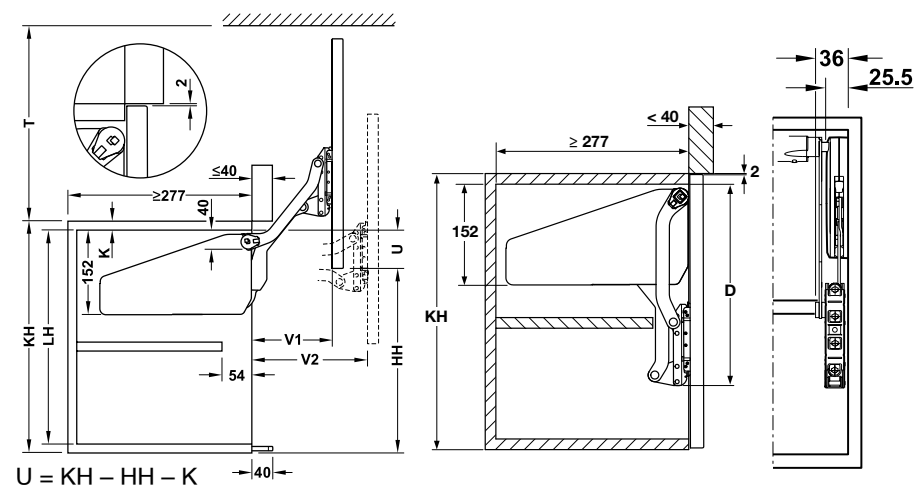

Cabinet height KH mm	D	LH mm	HH mm	T mm	V1 mm	V2 mm
320-360	274.5	>280	278	>281	128	177
345-420	302.5	>308	328	>333	146	205
380-500	337.5	>343	390	>393	168	240
430-600	382.5	>388	470	>473	196	284

FREE UP

Carcase Drilling Positions

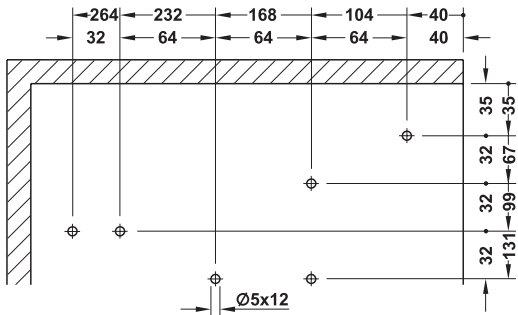

Front Panel Drilling Positions

Wooden / Wide Aluminium Framed Panel

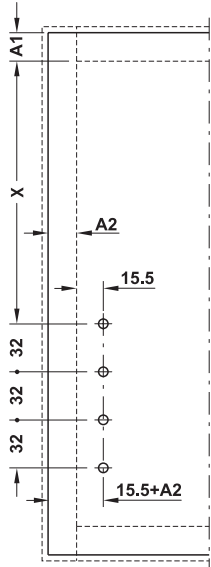

Cross Bar Installation

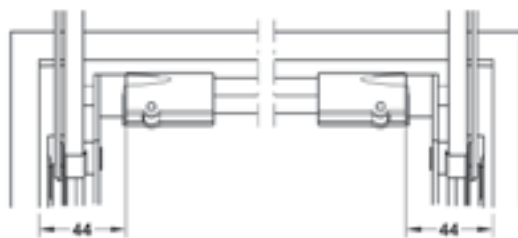

Cutting dimension = internal cabinet width – 88 mm

Narrow Aluminium Framed Panel

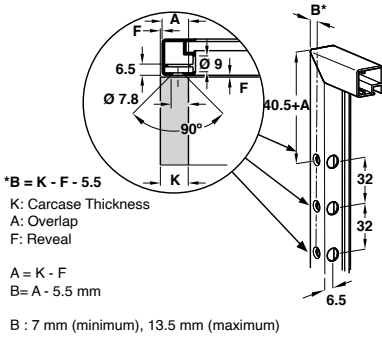

Installation

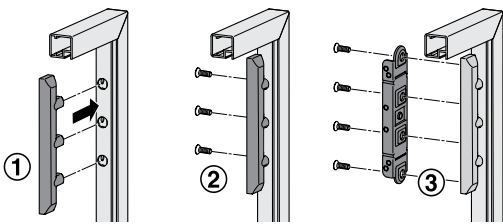

SCAN ME

FREE UP - E-DRIVE

- > **Free E-Drive is Häfele's electro-mechanical movement assistance for the entire application area of the Free flap fitting family**
- > The electrical drive solution is perfectly coordinated with all Free Lift Systems
- > Standard programming and operating functions for all Free E applications
- > The installation position and the range of applications of the Free Up fittings remain unchanged
- > Component installation can be done practically without tools
- > The E-Drive unit can be retrofitted at any time to the standard mechanical fitting
- > Extremely quiet and smooth running
- > With integrated free-swing function for effortless manual operation of the flap (even in the event of a power failure)
- > Automatic safety stop function interrupts the opening or closing movement if obstacles are detected
- > Parallel connection for up to three drive units, collision avoidance with cross-corner installations and temporary disabling of the drive to clean the flap fronts can also be programmed (optional)



- > Material: Fitting: Steel, Cover cap: Plastic, Drive housing: Zinc alloy
- > Finish/colour: Fitting: Nickel plated, Cover caps: Grey, white or anthracite
- > For cabinet height: 345–600 mm
- > For flap width: <1,200 mm (>1,200 mm = 2 sets)
- > Input voltage: 100–240 V AC/50–60 Hz/1.3 A
- > Nominal voltage: 24 V DC/3.75 A
- > Output voltage: For interior cabinet lighting: 24 V DC/1.2 A
- > Stand-by power consumption: 1 W
- > Radio frequency: 2.4 GHz
- > Protection class: II
- > Installation: E-Drive unit for screw fixing onto left Free fitting, Push button sender for recess installation in side panel (drill hole Ø 35 mm)

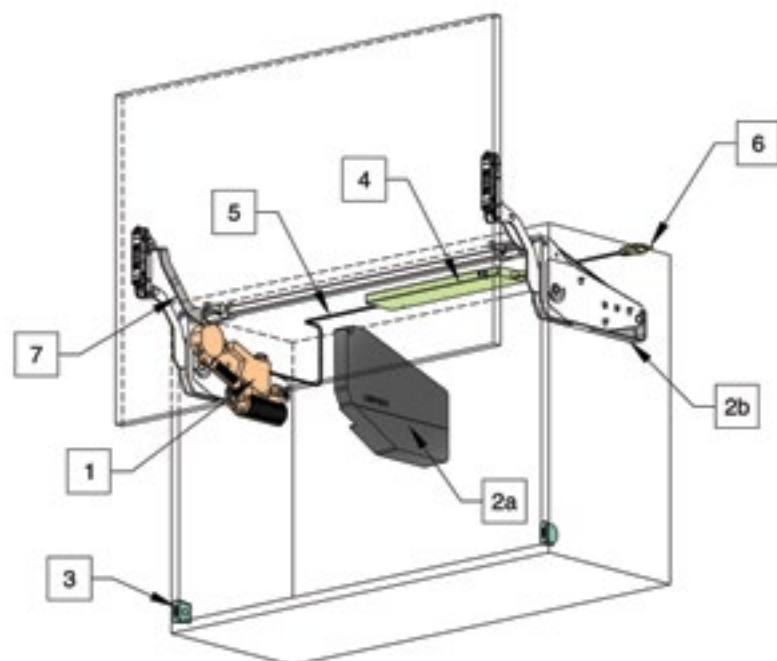

- 1 Free Swing E-Drive Mechanism
- 2a Cover Cap for E-Drive Mechanism
- 2b Cover Cap for Standard Mechanism
- 3 Push Button Switches
- 4 Loox 24V Driver
- 5 Connecting Cable
- 6 Loox Power Supply Cable
- 7 Free Swing E Drive Lever Arm

FREE UP - E-DRIVE

Ordering Information

Sets



E-Drive Set For Free Up*	
For Models	Article No.
Applicable for all Free Up models	372.38.164
*Consists of: 1 E-Drive Unit, 2 E-Drive Push Button Switches, 1 Loox Driver: 90 W - 24V, 1 Loox Power Supply Cable and 1 Connection Cable	



Free Up E Drive Cover Cap Set*			
Model	Anthracite	White	Grey
P	372.38.177	372.38.175	372.38.176
Q	372.38.180	372.38.178	372.38.179
R	372.38.183	372.38.181	372.38.182
*Consists of: 1 Cover Cap for E-Drive (left), 1 Cover Cap for Standard Fitting (right) and 1 E-Drive Lever Arm			

Unit: 1 Set

Individual Components



E-Drive Free Up Cover Cap Set*		
Anthracite	White	Grey
372.37.090	372.33.085	372.33.080
*Consists of: 1 Cover Cap for E-drive (left) and 1 Cover Cap for Standard Fitting (right)		

Unit: 1 Set



E-Drive Free Up Lever Arm		
Model	For cabinet height mm	Article No.
P	345–420	372.33.091
Q	380–500	372.33.092
R	430–600	372.33.093

Unit: 1 Piece



Free Up E-Drive Mechanism	
For Models	Article No.
A - G	372.37.099
*Consists of: Free Up E-Drive Mechanism and 2 E-Drive Push Button Switches	

Unit: 1 Set



E-DRIVE Push Button Switches	
Finish	Article No.
Grey	372.91.097

Unit: 1 Pair

- > Radio frequency: 2.4 GHz
- > Replaceable CR 2032 button cell lithium battery included



LOOX 24 V Driver	
Wattage	Article No.
90 W	833.77.949

Unit: 1 Piece

- > Only 1 E-Drive unit can be connected to one driver
- > Colour: Black
- > With overload protection
- > Degree of Protection: IP 20



LOOX Power Supply Cable		
Type of plug	Length	Article No.
EU	2000 mm	833.89.002

Unit: 1 Piece



Connecting Cable	
Length	Article No.
1400 mm	850.00.022

Unit: 1 Piece

FREE UP - E-DRIVE

Planning and Space Requirement

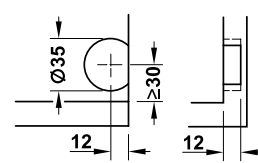
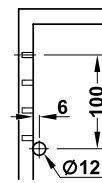
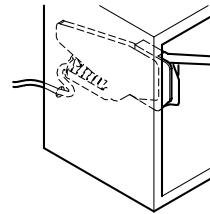
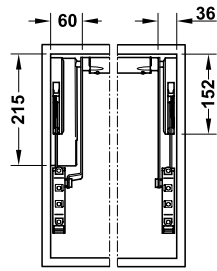
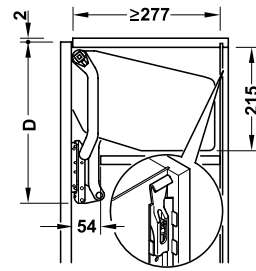

Cable Guide and Push Button Switch Installation

Installation and Programming



> The E-Drive drive unit sits on the left-hand fitting. The lead is simply inserted into the drive unit.

> 24 V interior cabinet lighting from the Loox product range can also be operated using the drive unit.
> The light switches on when the flap is opened.

> The push button sender assigning and the programming of other functions take place via a switching button directly on the drive unit. All programming processes are accompanied and acknowledged by visual and acoustic system feedback.

Operation



> Opening: The sensor switches, which are usually recessed in the side panels, react to gentle pressure on the flap front.
> They emit a radio signal and the flap moves quietly and automatically to the open position.

> Closing: Pressing the button on the inner surface of the sensor switch sends a radio signal to the drive, which then automatically closes the flap.
> The movement to the closed position takes place quietly and gently.

> The free-swing function integrated in all E-Drive drive units makes effortless manual operation of the flap applications possible.
> The multi-position stop function that is typical of the Free flap fittings ensures that the flap locks securely in any position.



SCAN ME



**Mumbai Design Centre:**

Haji Moosa Patrawala Ind.(SOBO)
Estate, Near Famous Studio,
Mahalaxmi (West), Mumbai - 400 011
Tel.: 022 6264 7100.

Mumbai Design Centre:

#2 Filix Building, Opp. Asian Paints,
L.B.S. Marg, Bhandup (West),
Mumbai - 400 078
Tel.: 022 2596 9660/
2596 9787/2594 7305

New Delhi Office & Design Centre:

D-89 , 1st Floor, Okhla Phase-I,
New Delhi - 110 020
Tel.: 011-66574999
Fax: 011-41605482

Bangalore Office & Design Centre:

Incubex Nestavera Spaces Pvt Ltd,
No:13, Langford Place, Langford Road,
Shanti Nagar, Bangalore - 560 025
Tel.: 080 4132 6116
Fax: 080 4132 6226

Bangalore**Hafele Appliances Gallery:**

No. 2/1, Shiv Manor, Langford Road,
Shantinagar, Bangalore - 560027
Tel.: 080 - 4142 6336

Hyderabad Office & Design Centre:

SJR Building - # 1-57/89/1 & 1-57/89/2
Opp Allahabad Bank, Gachibowli,
Hyderabad - 500032
Tel.: 040 29557578 / 040 29557588

Kolkata Design Centre:

PS PACE, Premises No. 1/1A,
Mahendra Roy Lane, Topsia,
Kolkata - 700 046
Tel.: 033 40086814 / 033 40089268
Fax: 033 24988020

Kolkata Office:

Office No. 1001, PS Continental,
10th Floor, 83/2/1 Topsia Road,
Near Vishwakarma Building.
South Kolkata - 700046
Tel: 033-2285 0104 /
033-2285 0105 / 033-2285 0106

Chennai Office & Design Centre:

1st Floor No.24, College Road,
Nungambakkam, Chennai - 600 006
Tel.: 044 - 4215 1542
Fax: 044 2446 0922

Pune Design Centre:

Showroom No. 2, Ground Floor,
F P no. 403, A/2, ICC Trade Tower,
Senapati Bapat Marg,
Shivaji Nagar, Pune -411016
Tel.: 020 2563 3301
Fax: 020 2563 3302

Pune Office:

Office No. 12, Vastushree Complex,
Survey No.587,
Near Hyde Park, Gultekdi,
Market Yard, Pune - 411 037
Tel.: 020 2426 6264
Fax: 020 2426 6274

Ahmedabad Office:

Hafele India Pvt. Ltd., Office No. 302,
3rd Floor, Shangrila Arcade, Near
Shyamal Cross Road, Satellite,
Ahmedabad - 380015
Tel.: +91 79695 55505 / 8866220505

Cochin Office:

Jomer Symphony, 5th Floor, 48/1744
C34, Chalikkavattom, North Ponnurrunni,
Vyttila, Cochin- 682010

Sri Lanka:**Hafele Office and Design Centre:**

52, Nandana Gardens
(On Duplication Road), Colombo 04.
Tel: +94 112 500 501.
Fax: 0094 112 500 553.

Hafele Design Centre:

448, Galle Road, Rawathawatta,
Moratuwa, Sri Lanka.
Tel.: +94 112 644 600.

Hafele Boutique:

747A, Sirimawo Bandaranayaka
Mawatha, Mulgampola,
Kandy, Sri Lanka.
Tel.: +94 812 223 338.

Bangladesh Office:

2nd Floor, House - 181, Road - 2,
Mohakhali DOHS, Dhaka - 1206.
Tel.: 01844018431/ 01844018432/
01844018433/ 01844018437.

Bangladesh Design Center:

House - 106, Road - 12,
Block - E, Banani, Dhaka - 1213
Tel.: 02-48810380-81

Nepal:

UHS Holdings Pvt. Ltd.
Kathmandu-2, Gairidhara Chowk, Nepal.
Mob.: +977 9802338800

Bhutan:**SMART HOMES**

Gr. Floor, Druk Building (Opp Helipad)
Babesa -Thimpu Expressway, Thimpu
Tel.: +975-2-333419
Mob.: +975-77277615, 17839717,
77114228,1760063,17669840

HAFELE

Mumbai Corporate Office:

Office No. 3, Building "A", BETA,
I Think Techno Campus, Off J.V.L.R,
Opp. Kanjurmarg East, Mumbai - 400 042.
Tel.: 022 6142 6100 | Fax: 022 6702 0531.

For Enquiries SMS "HAFELE" to 56070
Toll Free Customer Care: 1800 266 6667
Customer Care WhatsApp: +91 97691 11122
customer@hafeleindia.com
info@hafeleindia.com

Follow us on

