



SLIDO WALL



Introduction

Dear Customers,

Hafele has pioneered the way fittings are sold in India for many years now. Being a German company, our foremost concern has always been to offer our customers, premium quality products at competitive prices paired with solution based services. On the parallel, our focus has also remained to provide optimum functionality, enabling our customers to enjoy the benefits of effective utilization of space within and around their living, working or recreational environments. As a result of this, Hafele brings to you the advantage of 'space-efficiency' with its range of Movable Wall Systems from Netherlands that bring enormous versatility and design in dividing or uniting spaces in a given area.

Our Movable Wall Systems are backed by decades of experience and leadership in manufacturing proficiency and have the technological edge to expand to any possible imagination of designers. This applies specifically to the development of flexible space-saving solutions for hotels, congress or convention centres, schools, restaurants, shopping centres along with commercial and residential spaces. Our greatest strength remains to deliver customization in applications supported by standardization in quality and functionality.

Through this catalogue we bring to you two diverse categories for different movable partition options which can be realized in various applications. The Palace series with three models – Palace 80, 90 and 110, gives you the possibility of installing MDF partitions that are extremely easy to operate, ensure excellent sound insulation and can withstand extreme temperature fluctuations. An off-

shoot of the Palace series is the Transpalace system that allows you to install framed glass partitions - retaining the inherent benefits while also ensuring complete transparency within the room.

The President series offers you the possibility of installing seamless movable glass walls largely required in spaces like shops, cafes and restaurants, for instance. The biggest advantage of this series is that while it allows you to enclose private spaces within an area, its virtue of transparency retains the design and aesthetics of the room. All the Movable Wall Systems from Hafele come with efficient acoustic sealing to rule out the infiltration of any external noise.

We, at Hafele, offer optimal support to see the start of every project to its end - our team is at your service not only during the design and construction process but are also available to assist you for every technical and installation consultation.

So please enjoy this handy guide to quality space-saving ideas and solutions and get in touch with us with your requirements.

A handwritten signature in black ink, appearing to read 'Jürgen Wolf'.

Jürgen Wolf
Managing Director
(Hafele South Asia)

Hafele

Reassuring Expertise



"For over 9 decades, we've been helping people make more of their homes.

Established in Germany, and now operating worldwide, we specialise in the fittings, hardware and systems that improve the way your home works. So when you choose our products as part of your new or reformed home, you know you're getting the benefit of extensive knowledge and decades of experience.

And we're still a family business, owned and managed by family members who really care about the products

and service we provide. You can rely on our commitment to the highest standards of quality and reliability, founded on a long tradition of German engineering where attention to detail is second nature.

All our home improvement ideas are built to last – day in, day out – we want you to get the very best from every corner of your home, for many years to come."

Hafele

Worldwide



With its origin in 1923 in a small town named 'Nagold' from the Swabian region of Germany that nurses a passion for hardware technology, it is no surprise that Häfele has lived up to its roots through a successful presence in the architectural and furniture hardware industry for over 9 decades now. Today, Häfele's worldwide penetration includes 38 subsidiaries across Europe, America, Asia, Australia and New Zealand. With these subsidiaries and numerous other sales organisations, Häfele operates in over 150 countries. The Häfele headquarters, 4 manufacturing units and 10 sales offices are located within Germany; while 1 manufacturing unit is located at Budapest, Hungary. The company also owns one of the largest and most sophisticated warehouses in its home country. The Häfele worldwide workforce is empowered by a base of over 7600 employees.

The group services over 150,000 customers across the globe through its extensive range of hardware products and a comprehensive logistics system. In addition to this, Häfele also provides consultative services to its customers, educating and advising them about buying the correct hardware as per their requirements. With this level of market penetration and ability to handle worldwide demand, it comes as no surprise that the company is an authority in the segment of home interior solutions; what is pleasantly surprising, though, is that in spite of its size, Häfele still remains a family owned and run business with a unique, friendly and value-centric work culture which is strongly followed among all its subsidiaries.

Häfele India



Häfele India is a wholly-owned subsidiary of the Häfele Global network and has been operating in India since 2003 under the leadership of Mr. Jürgen Wolf (Managing Director). The ability of the company to understand the diverse Indian market has made it an authority in the field of architectural hardware, furniture and kitchen fittings and accessories. The company also has a strong presence in synergized product categories namely Appliances, Lights, Sanitary and Surfaces catering to the focused demand from these industries.

The subsidiary has a strong nation-wide presence with offices in Mumbai, Pune, Ahmedabad, Bangalore, Chennai, Hyderabad, Delhi and Kolkata. It has full-scale operations in Sri Lanka and Bangladesh with Regional offices and Design Showrooms in both the countries; and has also spread its sales operations to other countries in South Asia including Nepal and Bhutan.

Häfele's design showrooms are hubs of international home interior trends and cutting edge designs presented in a world-class environment, where customers can see home solutions in their inherent applications. These showrooms function as a one-stop-shop for all home interior and improvement needs - from providing in-depth technical advice to kitchen and wardrobe designing services through a team of experts stationed at the showroom.

Häfele India services its customers with a base of over 850 employees, a well-networked Franchise base of over 80 shops along with over 1000 dealers situated across South Asia. The subsidiary has a sophisticated Logistics centre in Mumbai along with distribution centres in Delhi, Bangalore, Kolkata and Colombo respectively.

360° Project Services

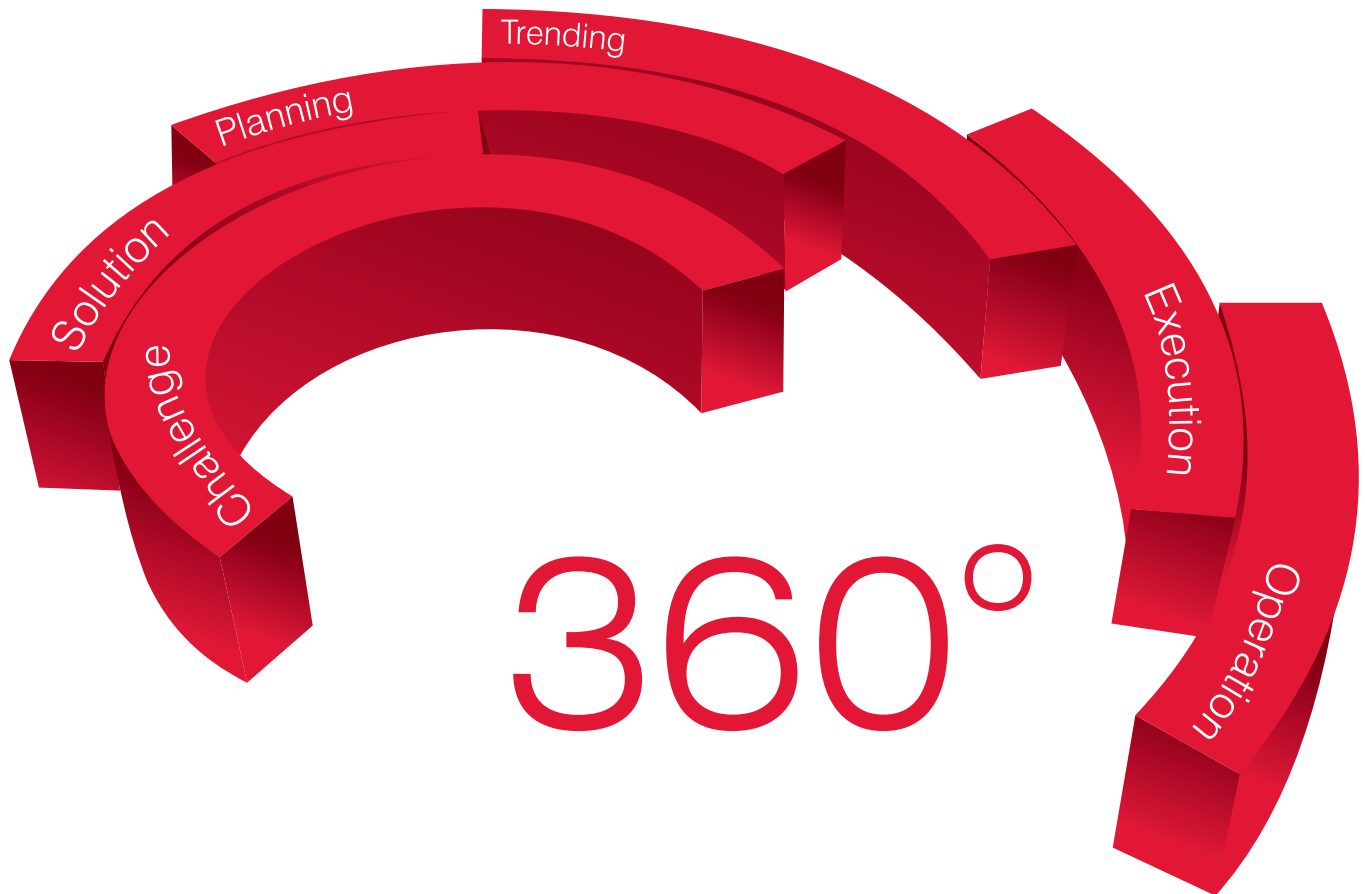

Globally, Häfele has created a strong international position as a “360 Degree Project Management Partner” with independent International Project Sales Offices deployed in the U.S. (North America), Germany (Europe) and Singapore (Asia). These Sales set-ups are constantly in touch with renowned Architects, Designers and Project Consultants from across the world and have the technical competencies to handle major International projects.

We offer complete services to these projects from accurate product specifications and efficient sales to adept installation guidance and support. This allows us to walk the length of the entire project duration by aiding and supporting our customers at every stage.

This global technical competency along with an in-depth understanding of international market trends forms the basis of our holistic service approach in South Asia. We can execute the most abstract solutions in any interior space by integrating functionality with cutting-edge designs; and this proposition is ably backed by our unified service network to ensure continued support

All you need to know about movable walls

Movable walls allow business owners and homeowners to create the floor plan they need out of a wide-open space. Movable walls are partitions that can increase the functionality of an open area such as a loft apartment, warehouse, conference room or banquet hall. These systems can provide privacy and good acoustic insulation for work and living environments.

Uses:

Movable wall panels are an ideal way to separate areas and create privacy in a room.

- Homeowners can select wall panels that create a solid wall and door for entry into a bedroom or living area or use glass panels to define separate areas of the living space while keeping the open floor concept in the room.
- In a business environment, movable walls are a quick way to set up offices and change the layout of the building space to accommodate new workers.



- Hotels and Malls can use movable walls to create more number of functional areas within the available space – for instance, a banquet hall or a convention centre in a Hotel can double up with a movable wall partition to accommodate two functions or conferences simultaneously.

Movable Wall Systems by Hafele:

Hafele brings to you its range of Movable Wall systems from Parthos, Netherlands. These systems are ideal for uniting or dividing spaces within a given area to achieve optimal space utility. Our range of movable wall systems gives you the flexibility of customization and conforms to the highest standards of functionality and quality.

Our products help to expand the imagination of designers. This applies especially to the development of flexible space-saving solutions for hotels, congress and convention centres, schools, restaurants, shopping centres, commercial buildings or large apartments.

Our greatest strength is our ability to deliver custom work.



Going the extra-mile; End-to-end solutions by Hafele:

While Hafele stands for excellence in quality and functionality, it is also recognized as your partner for end-to-end solutions.

- Our team of experts handhold you from the very start of a project with proficient advice and consultation in designing and planning
- We are available to see the maturity of the project with technical assistance in installation.

- Our assistance does not end here; we have a dedicated customer service helpline to assist you with any product operational issues and our service is only a phone call away.

We believe in giving you every possible convenience right from the time you approach us and through the very duration that you use our product functionalities!

What sets us apart?

1. Different Partition Materials: Through our holistic range of Movable wall systems, we give you the option of using different materials for your partitions – you could use solid MDF panels or opt for framed or seamless glass panels when transparency has to be retained.
2. Sound Insulation: As a range, our movable wall systems cater to sound insulation levels ranging from 36 dB Rw and can go as high as 58 dB Rw.
3. Flexible Panel Sizes: With our range of Movable Wall systems, you have the flexibility of erecting panels as high as 15 metres or more and as thick as 110 mm.
4. Fire Testing: Our range of movable wall systems is backed by extensive testing certifications to ensure that the end solution provided to you is not only durable but can also sustain such adversities, like fire break-outs.
5. Experience & Expertise: Over the last decade, Hafele has seen the fruitful completion of a number of domestic projects with our range of Movable Wall Systems. We are still in touch with all our clients to provide every possible after sales service and expertise or handle cases of renovations or redevelopment.
6. Parking Positions: With our range of Movable Wall systems, you can achieve every possible customization in parking positions:

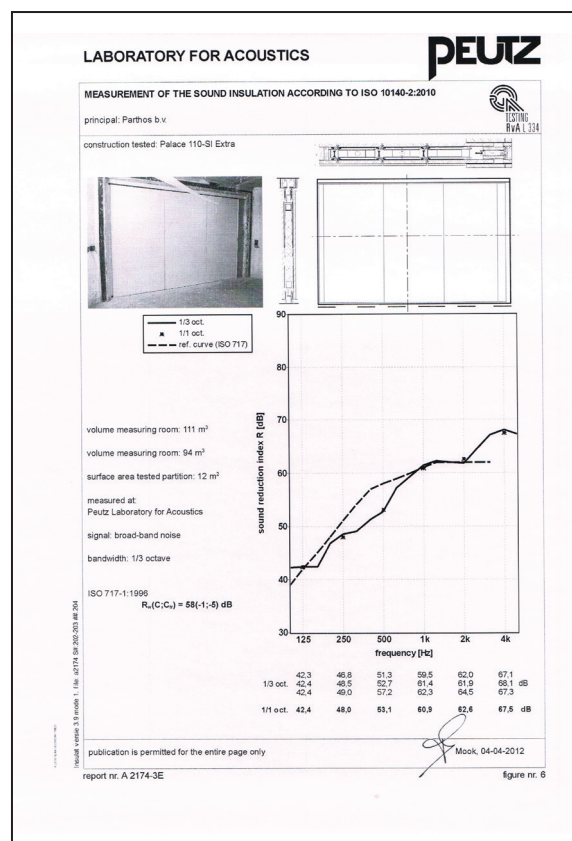
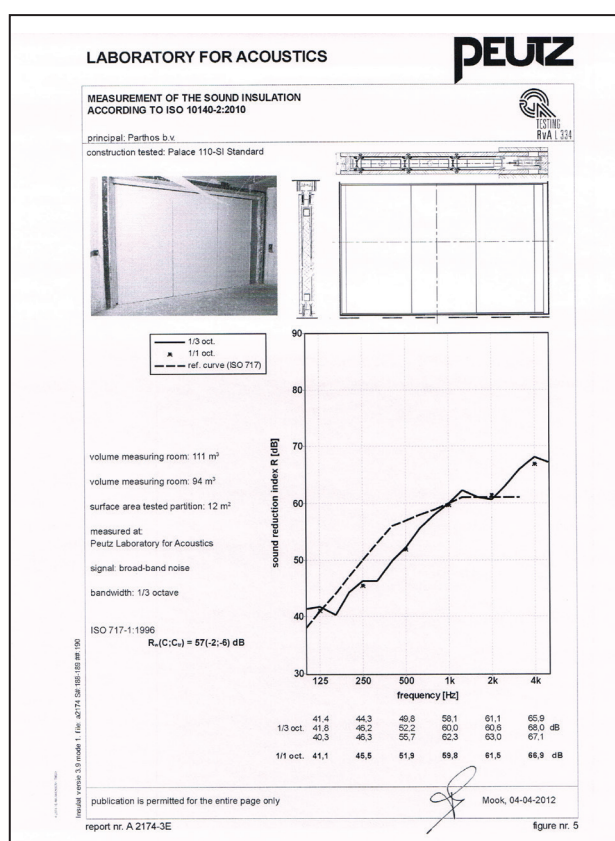

Palace

A flexible solution for every space

Our products help to expand the imagination of designers. This applies especially to the development of flexible space-saving solutions for hotels, congress and convention centres, schools, restaurants, shopping centres and commercial buildings. Our greatest strength is our ability to deliver custom work. The Palace series, especially, is proof of this: a durable movable wall that is extremely easy to operate. In addition to our standard models Palace 80, 90 and 110 we offer many other possibilities, all of them functional and fire-resistant, if required. The design can be tailored seamlessly to your project.

For instance, if you wish to divide a room without any loss of sound insulation and transparency, our latest model Transpalace may offer the best solution.

Every square metre of your area to be divided can be used as efficiently as possible. We offer durable and quickly realisable solutions for every work or meeting place. Of course, we also offer optimal support; not only during the design and construction process, but afterwards as well.







From tiny offices to huge conference halls: our stylish, functional Palace movable walls can give every space a new dimension.



In no time at all, Palace will enable you to divide a large space into smaller units. Thanks to our extensive experience with bearing technology and the rolling properties of a variety of different materials, we can find a high-quality, durable rail and trolley construction for every application that will also ensure an optimal ease of operation. (Floor guidance mechanisms will not be an obstruction to your floor.)

Stability as well as perfect sound insulation are two typifying characteristics of Palace walls. The spindle mechanism and the so-called acoustic pressure sleeves secure the different panels firmly between the floor and the track. In addition, the parking possibilities are virtually unlimited.



Palace 80

For many types of users, the Palace 80 may very well be the ultimate solution for creating more space and flexibility.

This movable wall with a panel thickness of only 80 mm will guarantee an optimal ease of operation with only the slightest loss of space. The favourable cost aspect also makes it an excellent alternative. Furthermore, the Palace 80 proves that a slim construction does not affect the stability and sound insulation.

The trolleys of this wall are suspended on metal bearers running horizontally through the panel. The result is a self supporting structure.





- Standard version with covering profiles
- Very easy to operate due to light construction
- High-quality track and trolley system
- Stable and self-supporting frame construction
- Enormous flexibility thanks to a broad range of panels



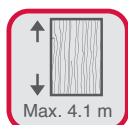

Palace 90

The Palace 90 is a paradigm of robust custom work. In spite of its slim look, the Palace 90 disposes of an extensive package of functional characteristics. Furthermore, this type of wall is suited to every (working) environment.

The inlaid aluminium border profiles give it an especially stylish look.





- New EPDM pressure sleeve and pieces for improved acoustic properties
- Standard version with inlaid profiles
- Stable and self-supporting frame construction
- Enormous flexibility thanks to a broad range of panel models
- Attractively priced
- Very easy to operate
- High-quality track and trolley system

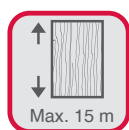

Palace 110 S

The Palace 110 makes it much easier to organise your space: a high degree of sound insulation, single or double doors, height of more than fifteen metres, curved panels if required, semi-automatic operation and fire resistance rating of up to sixty minutes!



- Durable and stable metal construction
- Possible heights of more than 15 metres
- Optimal flexibility, curved walls and tracks possible
- Available in a fire-resistant model of up to 30 and 60 minutes with passdoor
- Available in a broad range of finishes
- High-quality track and trolley system
- L- shaped semi-automatically operated top & bottom seals possible



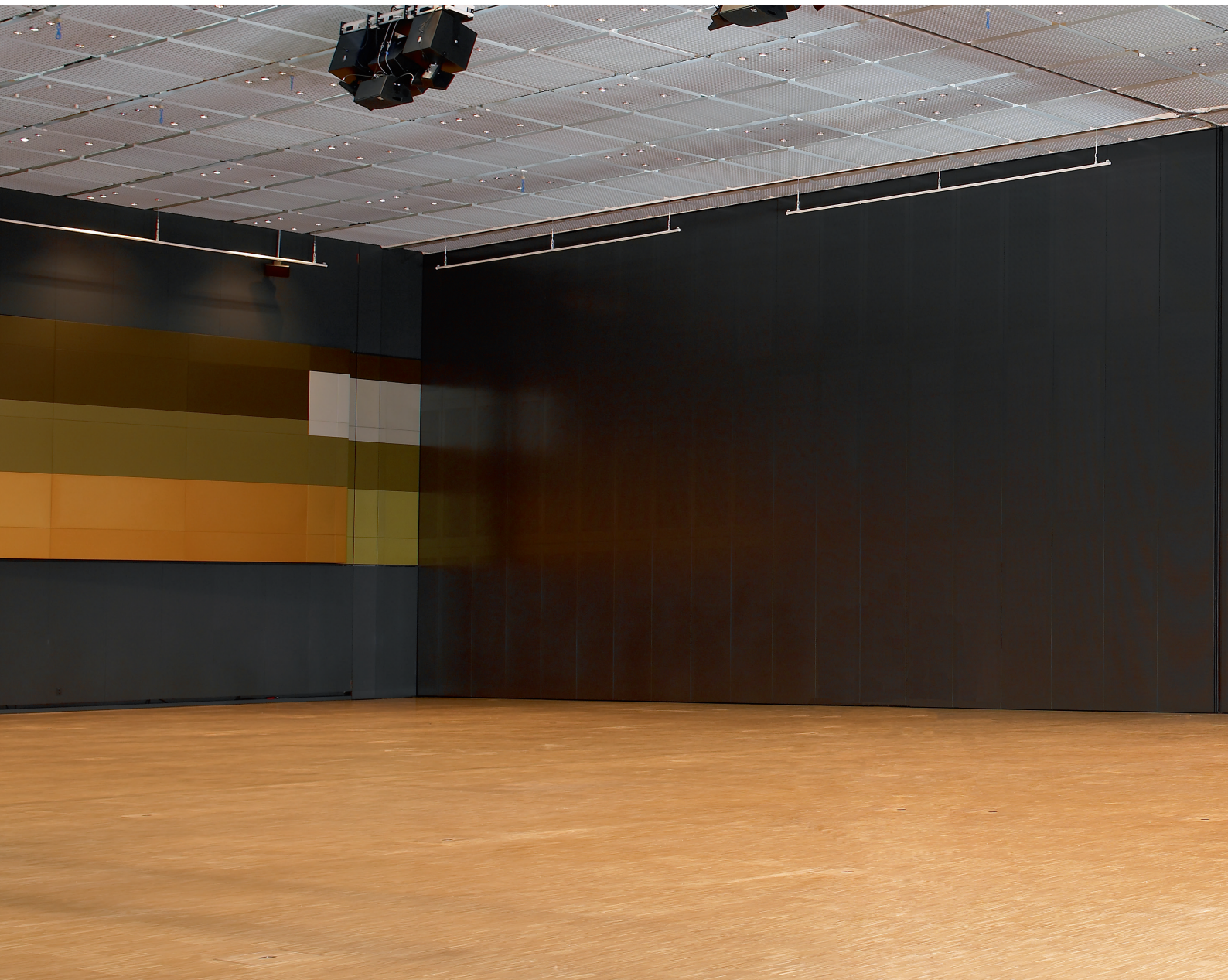

Design

Efficiency and safety, as well as aesthetics and stability: That is what the Palace 110 stands for. This robustly executed movable wall satisfies even the toughest requirements.

The Palace 110 proves that quality and design can be perfectly integrated. This wall can be adapted to suit every interior design. There are countless possibilities as to shape, material, colour, finished edges, corner elements and glass openings. Even curved walls and tracks can be delivered.

The Palace 110 is perfectly suited to create silence, with panels measuring only 110 mm in thickness. Even when this concerns heights of more than 15 meters. Custom solutions are our specialty. In consultation with Hafele, you can determine the parking positions and the lay-out of the track, tailored to your personal requirements.

For those who require a product that is extremely easy to operate, our semi-automatically operated movable walls may be the very best solution. Hafele aims to deliver products that are completely tailored to your needs.





Transpalace

The most exclusive model in the Palace series is the Transpalace. This sturdy, transparent movable wall has been finished with double-layer safety glass. Transpalace will allow you to retain the transparency, while enjoying what the other Palace walls have to offer, such as a high degree of sound insulation, a stable frame and a beautiful design. The technology has been subtly incorporated behind a thin panel of glass, in the colour of your choice.





- Glass can be replaced separately
- Aluminium profiles, available in every RAL colour chart system
- Slim glass available in every colour
- Welded aluminium/steel construction

President

Clear options for every space

Movable glass walls offer a variety of applications: in shops, hotels, cafes and restaurants and government, banking and insurance buildings, for instance. The President series makes it easy for you to create privacy, while its transparency and open look and feel will allow the space itself to remain intact. Thanks to its slim construction, this functional and stable wall will take up only a remarkably small amount of space in a parked position.

From shopping-arcade to reception area: the President is stylish and will let in plenty of light. For additional privacy, the glass can be etched, sandblasted or decorated with foil.

Your company logo, texts and entire designs can also be added. Because we develop and produce the President series completely under its own management, there is practically no limit when it comes to turning creative ideas in to practical solutions.

A selection can be made, for instance, between straight and curved, as well as segmented panels. Let your imagination run free and discover, with the help of our consultants, which movable glass wall will be shown to its best advantage in your project!



Advantages of a well engineered design

Perfection to even the tiniest details: that's one of our typifying characteristics. From raw materials and a perfectly monitored production process to finished products of the finest quality. Our standard options include an extensive choice of glass types and finishes. Regardless of whether your interior is dominated by light or dark colours: the aluminium parts of our President series are available in

nearly every colour imaginable. An important detail: the glass panels of the President series have been developed so that vertical aluminium profiles will not be necessary. So no matter where your wall is to be installed, you can always choose an unbroken design without the obstruction of unnecessary frames. Clarity and transparency are among our highest priorities.





President

An enormous degree of user-friendliness and an extensive range of options as to design and finish are among the President's greatest advantages. In addition to design, we also pay a great deal of attention to user-friendliness.





- Completely transparent partition
- Curved segmented models available
- Virtually unlimited choice of options in pattern and design
- High-quality track and trolley system
- Extremely durable clamping construction without necessity of drilling the glass
- Profiles and track available in several colours

Fire Resistance



Hafele continually improves its products and invests heavily in product development. As a result of this, we are always aspiring to the needs and desires of our customers and developing new solutions for them. Keeping this in mind, we partner with only such brands who lay great emphasis on quality and innovation.

Our SLIDO Walls partner, Parthos pays close attention to the European directives concerning fire safety of building products. Fire resistance of movable walls depends on the behaviour of the wall construction when subjected to fire.

Specifically spread of flame and thermal insulation are important criteria. Various tests (in accordance with EN 1364) with renowned Institutes have proved that Parthos is able to produce a movable wall, with integrated pass door, with a 30 minutes fire resistance. A reputation is established!

So when fire resistance is a must, you have the choice of the Parthos Palace supplied in EI30 or even EI60 classification.

Sound Insulation



The sound insulation of a movable wall is defined by International Standard Laboratory measurements in accordance with ISO 140-3.

In building practice however, there will never be an ideal laboratory situation. The sound insulation between two rooms will always be affected by the surrounding construction. Generally the sound insulation will deviate approximately 5 to 10 dB from the laboratory measurement. Sound waves will pass through and under flooring (carpet), through walls and windows, above suspended ceilings and through ventilation ducts. These aspects must all be taken into account when selecting the appropriate wall system and the required demands of the rest of the building. Adding integrated pass door(s) also affects the sound insulation. This, in combination with proper operation and maintenance of the wall, will define whether the desired sound insulation is achieved or not.

We will help you with pleasure! Through our long experience we can advise you at the design stage in order to improve the acoustics of your room.

Track Details

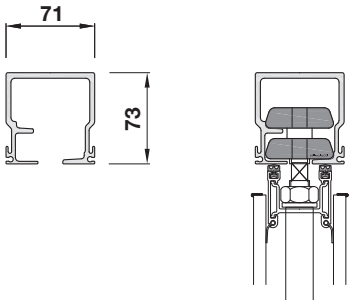
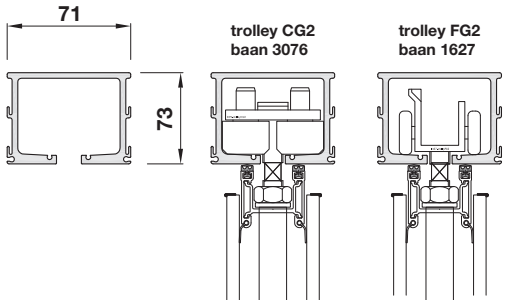
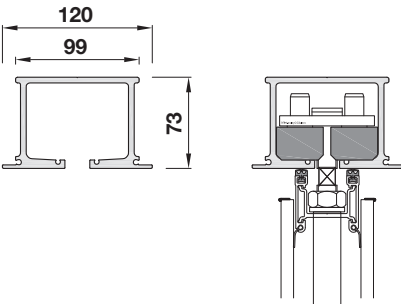
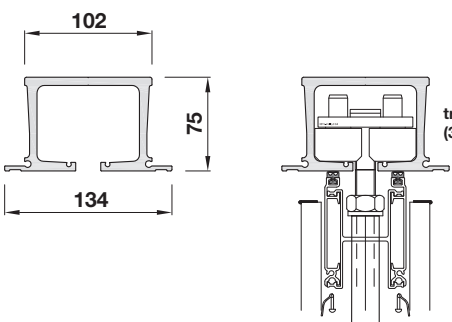
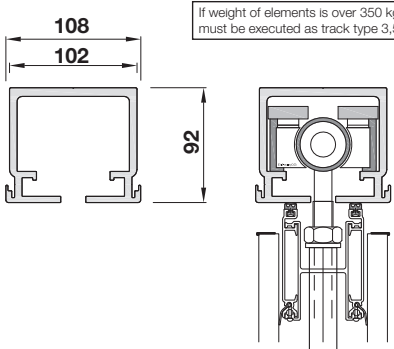
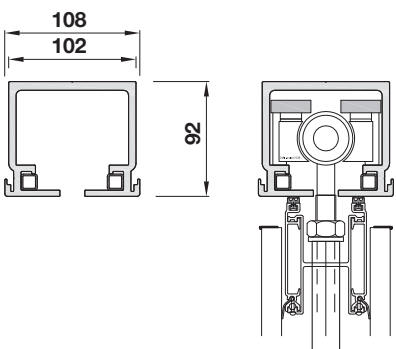
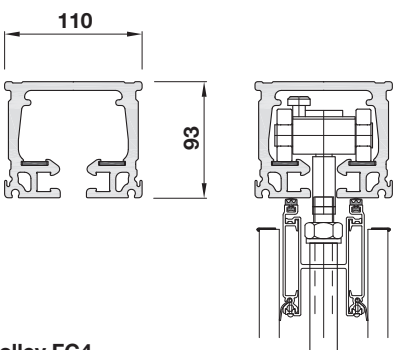
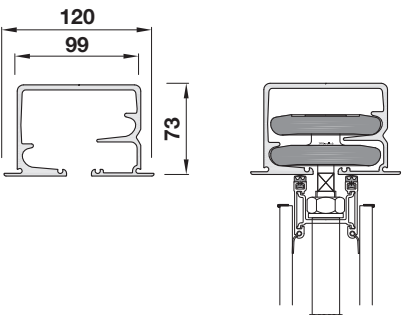
<div data-bbox="156 324 762 622">  <p>track 1 baan 3412</p> <p>trolley CG1 baan 3411</p> </div> <div data-bbox="156 667 399 723"> <p>track 1 & trolley CG1 Cross Guidance (CG) only</p> </div>	<div data-bbox="815 324 1401 622">  <p>track 2 baan 2637</p> <p>trolley CG2 baan 3076</p> <p>trolley FG2 baan 1627</p> </div> <div data-bbox="866 667 1326 723"> <p>track 2 & trolley CG2 Cross Guidance (CG) or One point Guidance (OG)</p> </div>
<div data-bbox="156 772 774 1075">  <p>track 2c baan 3478</p> <p>trolley silent baan 3784</p> </div> <div data-bbox="156 1131 531 1187"> <p>track 2c (or 2) & trolley CG2 - "silent" Cross Guidance (CG) only</p> </div>	<div data-bbox="815 772 1436 1093">  <p>track 2rc (3218)</p> <p>trolley 2cg (3076)</p> </div> <div data-bbox="866 1131 1101 1187"> <p>track 2rc & trolley CG2 Cross Guidance (CG)</p> </div>
<div data-bbox="156 1243 766 1590">  <p>track 3 baan 3310</p> <p>trolley CG3 baan 3315</p> </div> <div data-bbox="156 1585 368 1641"> <p>track 3 & trolley CG3 Cross Guidance (CG)</p> </div> <div data-bbox="464 1243 766 1283"> <p>If weight of elements is over 350 kg, parking tracks must be executed as track type 3,5 (re-enforced)</p> </div>	<div data-bbox="866 1243 1505 1590">  <p>track 3,5 baan 2188</p> <p>trolley CG3,5 baan 3691 (solid steel wheels)</p> </div> <div data-bbox="866 1585 1117 1641"> <p>track 3,5 & trolley CG3,5 Cross Guidance (CG)</p> </div>
<div data-bbox="156 1697 769 2045">  <p>track 9 baan 3213</p> <p>trolley FG4 baan 3519</p> </div> <div data-bbox="156 2029 367 2085"> <p>track 9 & trolley FG4 Forced Guidance (FG)</p> </div>	<div data-bbox="866 1697 1460 2011">  <p>track 5 baan 3493</p> <p>trolley CG5 baan 3495</p> </div> <div data-bbox="866 2029 1326 2085"> <p>track 5 & trolley CG5 Cross Guidance (CG) or One point Guidance (OG)</p> </div>

Palace 80/90

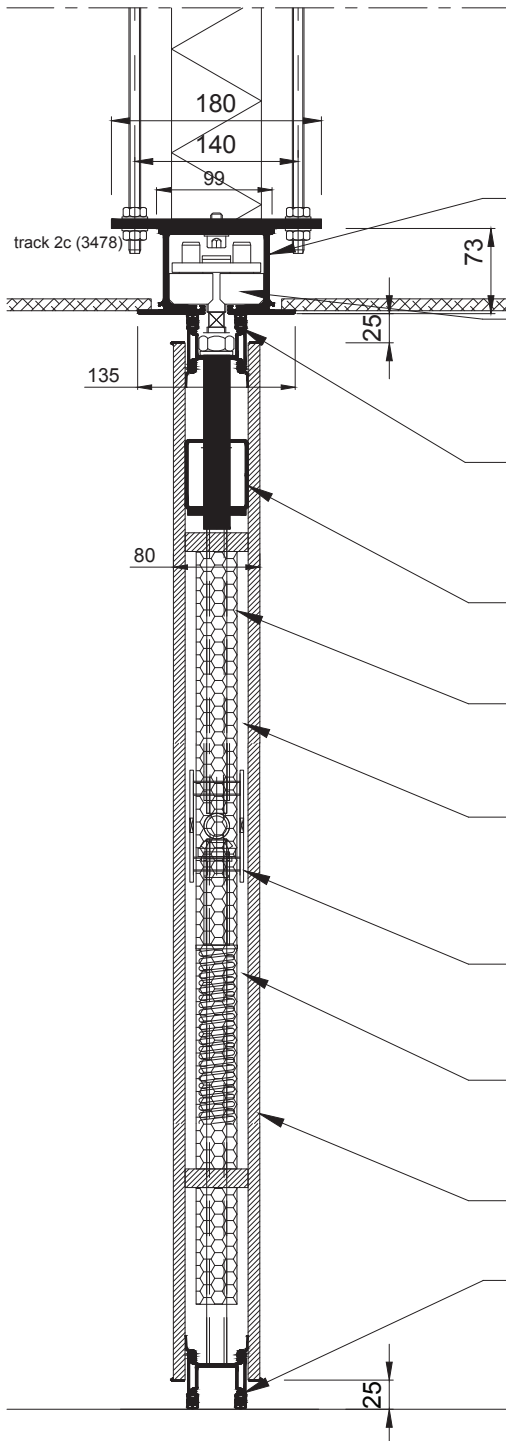

Movable walls Parthos-Netherlands type Palace 80 Elements thickness 80mm.

Track Type 2C/2RC

Material Aluminium Extrusion-6005A F27 T6

Trolley Type FG2/CG2

Galvanized Steel Cold JIS STKM12,

Free Maintenance Trolley with self Lubricating multiple ball bearings

Retractable Sound Seal black Anodized Aluminium Extrusion-6063 T5 with EDPM Rubber

Frame of Zinc coated Steel tube(Cold JIS STKM12)

Aluminium Anodized profiles Extrusion-6063 T5,with edge protecting

Acoustic Material:

-Rockwool: 45kg/M3 for sound insulation,hot and cold transmission

Tight closure between the panels by EPDM Rubber

Galvanized spindle mechanic for the Retractable sound seals
Pressure force of 1500 newton

MDF/HMR boards 8/9mm

Retractable Sound Seal; black Anodized Aluminium Extrusion-6063 T5 with EDPM Rubber

Palace 110 S

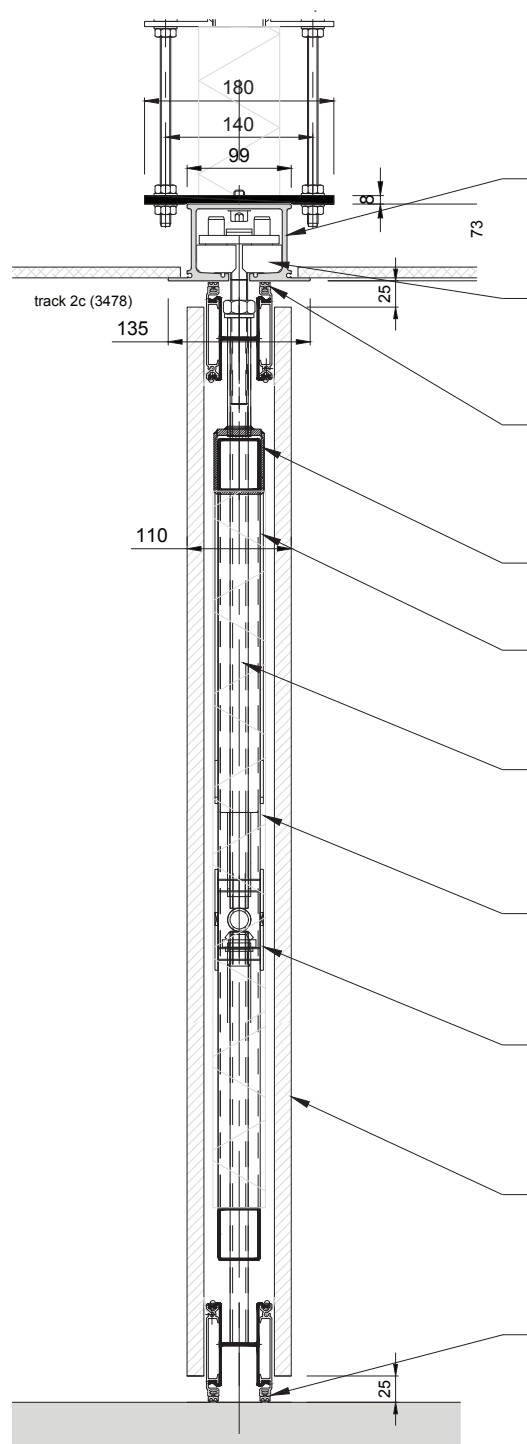

Movable walls Parthos-Netherlands type Palace 110S Elements thickness 110mm.

Track Type 2C/2RC/3.5/9
Material Aluminium Extrusion-6005A F27 T6

Trolley Type FG2/CG2/CG3/FG4
Galvanized Steel Cold JIS STKM12,
Free Maintenance Trolley with self Lubricating multiple ball bearings

Retractable Sound Seal black Anodized Aluminium Extrusion-6063 T5
with EDPM Rubber

Frame of Zinc coated Steel tube(Cold JIS STKM12)

Aluminium Anodized profiles Extrusion-6063 T5,with edge protecting

Acoustic Material:
-Rockwool: 45kg/M3 for sound insulation,hot and cold transmission
-Damping sheet for higher dB Rating (53/56/57/58dB)

Tight closure between the panels
by EPDM Rubber and magnetic seals, contact pressure of 55
newton / meter

Galvanized spindle mechanic for the Retractable sound seals
Pressure force of 1500 newton

MDF/HMR boards 16 /18 mm: free swinging suspended and
acoustically separated from the steel frame by EDPM press seals
in case of surface damage, the face boards can be replace
without removing the frame from the track

Retractable Sound Seal; black Anodized Aluminium Extrusion-6063
T5 with EDPM Rubber

Slido Wall Product Options Technical Details

Cross sections of panel joints

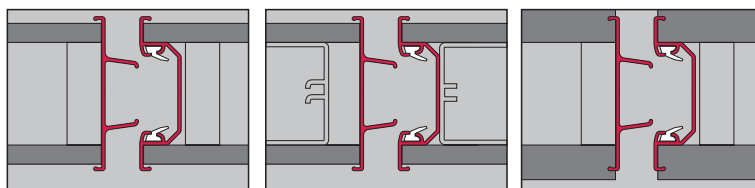

Type	80	Transpalace	90
Panel thickness	80 mm	80/100 mm	90 mm
Panel height	1500-3500 mm	1500-3500 mm	1500-4000 mm
Panel width	600-1240 mm	600-1240 mm	600-1240 mm
Frame construction	aluminium / wood	aluminium	aluminium / wood
Board material	9 mm, carried by the construction	10 mm safety-glass carried by the construction	8 mm, carried by the construction
Fire safety	optional fire-retardant class B1/M1	optional fire-retardant glass	optional fire-retardant class B1/M1
Vertical profiles	aluminium, anodized, with sealing profiles	aluminium, anodized, with sealing profiles	aluminium, anodized, with sealing profiles invisible when wall is closed
Pressure sleeves	aluminium, black with double sealing profiles	aluminium, black with double sealing profiles	aluminium, black with double sealing profiles
Operation of pressure sleeves	manual	80: manual 100: electrical	manual
Doors	single door in panel or fixed single door	single door in panel or fixed single door*	single door in panel or fixed single door
Sound insulation	40 and 44 dB Rw	44 / 46 dB Rw	46 and 48 dB Rw
Weight (depending on sound insulation value)	approx. 40 & 44 kg/m ²	approx. 65 kg/m ²	approx. 32-50 kg/m ²

The dB-values have been measured according to ISO 140, Rw value established according ISO 717.
Test reports available on demand.

* Door elements not in glass, will be solid

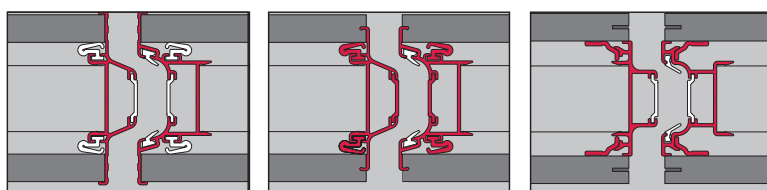

110 S		110 SI		110 S F30/F60	
110	mm	110	mm	110	mm
1500-15000	mm	1500-15000	mm	1500-15000	mm
600-1240	mm	600-1240	mm	600-1240	mm
steel / aluminium		steel / aluminium		steel / aluminium	
16 mm, carried by the construction		16 mm, carried by the construction		16 mm, fire-retardant class B1/M1, carried by the construction	
optional fire-retardant class B1/M1		optional fire-retardant class B1/M1		30 mins / 60 mins fire-resistant	
aluminium, anodized with magnetic strips and sealing profiles		aluminium, anodized with magnetic strips and sealing profiles, invisible when wall is closed		aluminium, anodized with magnetic strips, sealing profiles and fire protecting strips invisible when wall is closed	
aluminium, black with double sealing profiles		aluminium, black with double sealing profiles		aluminium, black with double sealing profiles and fire resistant strips	
manual or electrical		manual or electrical		manual	
single or double door in panel or fixed single door		single or double door in panel or fixed single door		single or double door in panel or fixed single door	
45, 50, 53, 56, 57, 58 dB Rw		45, 50, 53, 56, 57, 58 dB Rw		45, 50, 53, 56, 57, 58 dB Rw	
approx. 31-56 kg/m ²		approx. 31-56 kg/m ²		approx. 33-65 kg/m ²	

Other product versions and sizes on request.

We will be pleased to supply you with detailed (technical) information.

Parking Examples

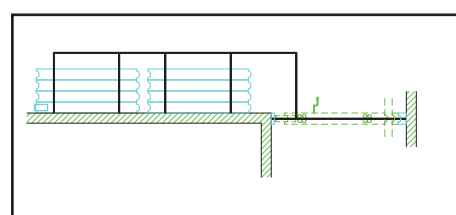
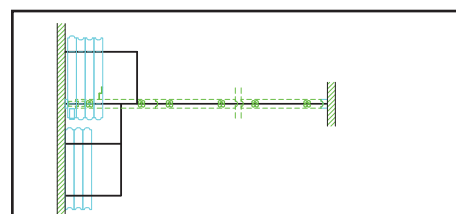
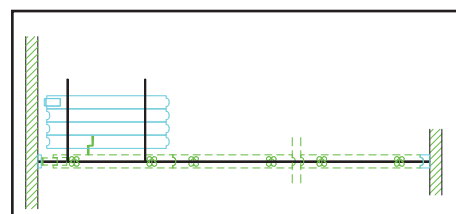
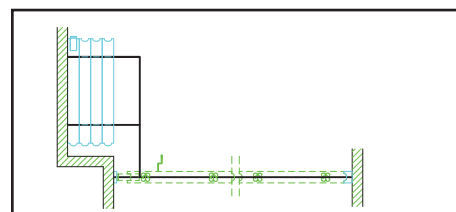
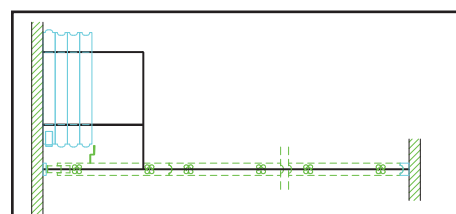
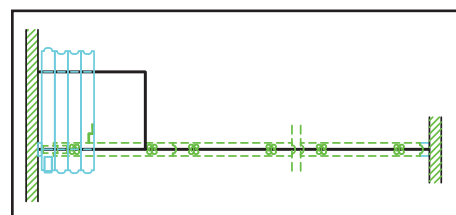
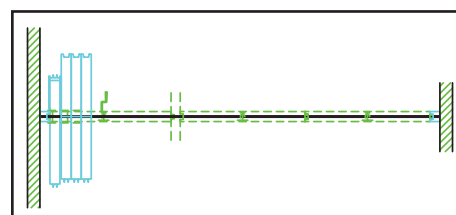

Reference List of Parthos movable walls INDIA - HOSPITALITY

• Grand Hyatt Hotel & Convention	-	Cochin	• Royal Orchid Hotel	-	Hyderabad
• One Convention (11.7 mtr)	-	Hyderabad	• Royal Orchid Hotel	-	Pune
• Anvaya Convention (7.8 mtr)	-	Hyderabad	• Sarovar Park Inn Suits	-	Bangalore
• Manjeera Convention	-	Rajahmundry	• GRT Hotel	-	Bangalore
• Vizag Convention (7.3 mtr)	-	Vizag	• Prestige Habitat	-	Bangalore
• A Convention Center	-	Vijayawada	• Pancharatna Hotel	-	Bangalore
• A Plus Convention Center	-	Vijayawada	• Park Plaza Hotel	-	Faridabad
• AB Convention Center	-	Vijayawada	• Amby valley Resorts	-	Lonavala
• Amaravathi Convention Center	-	Vijayawada	• Pride Hotel	-	Nagpur
• Murali Fortune Convention	-	Vijayawada	• Canyon Resorts	-	Raipur
• SS Convention Center	-	Vijayawada	• Four season Hotel	-	Mumbai
• A One Sai Convention Center	-	Ongole	• The Club (Holiday Inn)	-	Mumbai
• A Convention Center	-	Amalapuram	• Fern Hotel	-	Hyderabad
• Karthik Convention Center	-	Guntur	• Golkonda Hotel	-	Hyderabad
• JW Marriott Hotel (9.5 mtr)	-	Jaipur	• Golkonda Resorts	-	Hyderabad
• Chiraan Fort	-	Hyderabad	• Oakwood Hotel	-	Bangalore
• Hilton Hotel	-	Agra	• Howard Johnson Hotel	-	Bangalore
• Hilton Garden Inn	-	Lucknow	• The Waves Hotel	-	Jaipur
• Novotel Hotel	-	Ahmedabad	• Hotel Lords Inn	-	Agra
• Novotel Hotel	-	Guwahati	• Madhuban Resorts	-	Ahmedabad
• Novotel Hotel	-	Kolkata	• ANV Hotel	-	Amritsar
• Holiday Inn	-	Kolkata	• Trillium mall Banquets	-	Amritsar
• Holiday Inn	-	Cochin	• Galaxy Mall	-	Asansol
• Tamara Hotel	-	Trivendrum	• Bell Tower Hotel	-	Bangalore
• SAS Residency	-	Coimbatore	• Citrin Hotel	-	Bangalore
• My Fortune ITC Hotel	-	Coimbatore	• RK Regent Hotel	-	Bangalore
• My Fortune ITC Hotel	-	Durgapur	• Wonderla Holidays	-	Bangalore
• My Fortune ITC Hotel	-	Lucknow	• Veegaland Hotel	-	Cochin
• Taj Surya (Semi Automatic)	-	Coimbatore	• Olive Hotel	-	Cochin
• Taj Coromandal Hotel	-	Chennai	• Amaya Banquets	-	Delhi
• Taj Gateway Hotel	-	Chennai	• Hotel Vasant Continental	-	Delhi
• TRIL Infopark Ltd	-	Chennai	• Pitampura Hotel	-	Delhi
• Matsya Restaurant	-	Chennai	• Jaypee Hotel	-	Delhi
• Taj Dwaraka (8300 mm high)	-	Delhi	• Hotel Shriram	-	Dhanbad
• Taj Vivanta Hotel	-	Guwahati	• Nandan Hotel	-	Guwahati
• Taj Gateway Hotel	-	Nashik	• Beltola Banquets	-	Guwahati
• Taj Gateway Hotel	-	Surat	• Daspalla Hotel	-	Hyderabad
• Taj Vivanta Hotel	-	Trivendrum	• Gurupreeth Hotel	-	Hyderabad
• Taj Vivanta	-	Lucknow	• Hotel Sapthagiri	-	Hyderabad
• JW Marriott Hotel	-	Bangalore	• The Twin Oaks Banquets	-	Bangalore
• JW Marriott Hotel	-	Shillong	• Tranquility Club	-	Bangalore
• Courtyard Marriott Hotel	-	Bilaspur	• Hotel Shubh Inn	-	Bhopal
• Lulu Marriott Hotel	-	Cochin	• The World Hotel	-	Bhubaneswar
• Lulu Teck Park	-	Cochin	• Bodhagaya Hotel	-	Bodhgaya
• Four Point Sheraton	-	Cochin	• Spectrum Inns & Motels	-	Chandigarh
• Marriott by Tribute	-	Cochin	• Ishaan Hospitality	-	Chandigarh
• Fairfield Marriott Hotel	-	Bangalore	• Hotel Windsor Rajadhani	-	Cochin
• JW Marriott Chalet Hotel	-	Mumbai	• Inner Circle Hotel	-	Hyderabad
• J W Marriott Hotel	-	Jaipur	• KIMS Hospital	-	Hyderabad
• Hyatt Hotel	-	Goa	• Maheswari Hotel	-	Hyderabad
• Premier Inn Hotel	-	Goa	• Spice Village Hotel	-	Hyderabad
• W Hotel	-	Goa	• Ramoji Film City	-	Hyderabad
• The Park	-	Indore	• Bagga Hotel	-	Hyderabad
• Premier Inn Hotel	-	Chennai	• KCP Mercure Hotel	-	Hyderabad
• SRM Hotel	-	Chennai	• Swagath Grand Banquet	-	Hyderabad
• Oberoi Hotel	-	Chandigarh	• Middleton Hotel	-	Kolkata
• Best Western Hotel	-	Chandigarh	• Stadel Hotel	-	Kolkata
• Dusit Hotel	-	Delhi	• Park Plaza Hotel	-	Kolkata
• Golden Tulip Inn Hotel	-	Delhi	• Ashoka Hotel	-	Kolkata
• Golden Tulip Hotel	-	Lucknow	• Peerless Inn Hotel	-	Kolkata
• Golden Tulip Hotel	-	Shimla	• Lakesong Resorts	-	Kumarakom
• Radisson Blu	-	Bangalore	• Charan Plaza Hotel	-	Lucknow
• Radisson Blu	-	Mysore	• Dukes Resorts	-	Lonavala
• Radisson Blu	-	Agra	• Della Adventures	-	Lonavala
• Regenta Hotel	-	Rajkot	• Astor Hotel	-	Jemshedpur
			• Camellia Axis Mall Banquets	-	Kolkata

• Sea princess Hotel	-	Mumbai
• Hotel Center Point	-	Nagpur
• Anandha Inn Hotel	-	Pondicherry
• Sun and Sand Hotel	-	Pune
• NS Hotel	-	Pune
• Barsana Hotel	-	Siliguri
• Gautham Residency Hotel	-	Tenali
• PLA Residency Hotel	-	Trichy
• Hotel Yespee Grand	-	Trivendrum
• Windsor Rajadhani Hotel	-	Trivendrum
• Hotel Lavlaxmi	-	Varanasi
• Minerva Grand Hotel	-	Vijayawada
• Mini Hotels & Resorts	-	Vijayawada

INDIA – PROJECTS

• Statue of Unity	-	Ahemdabad
• Oracle	-	Bangalore
• Mercedes Benz	-	Bangalore
• PWC Ltd (Price Water Coopers)	-	Bangalore
• Alti Source software Ltd	-	Bangalore
• Cargil Project	-	Bangalore
• Arista project	-	Bangalore
• Seagate Project	-	Bangalore
• ITC Factory	-	Bangalore
• Centrix office	-	Bangalore
• Swiss Re	-	Bangalore
• Alstom	-	Bangalore
• Head Infotech Pvt Ltd	-	Bangalore
• Tech Systems	-	Bangalore
• JLL TDIM	-	Bangalore
• SNN Greenbay	-	Bangalore
• Oracle ODP	-	Bangalore
• Decathalon	-	Bangalore
• Standard Chartered Bank	-	Bangalore
• Lowes Project	-	Bangalore
• ETV Office (JPMC)	-	Bangalore
• SCHUNK	-	Bangalore
• DB Corp Ltd	-	Bhopal
• Atishey Infotech	-	Bhopal
• PWC Ltd (Price Water Coopers)	-	Chennai
• Infosys	-	Chennai
• IBM	-	Chennai
• Mahindra Lily Housing	-	Chennai
• Dr.Agarwal Eye Clinic	-	Chennai
• Ford	-	Chennai
• Toyota Nippon Showroom	-	Cochin
• E & Y Project	-	Cochin
• Lanco Infratech Limited	-	Delhi
• Planning Commission	-	Delhi
• Shriram Piston and Rings Ltd	-	Delhi
• Firestar Diamond Pvt Ltd`	-	Delhi
• DCM Shriram Consolidate Ltd	-	Delhi
• Indigo Project	-	Delhi
• Angsana Club	-	Delhi
• Jaguar India Pvt.Ltd	-	Delhi
• Admiral Project	-	Delhi
• Invest India	-	Delhi
• BMR Project	-	Delhi
• French Embassy	-	Delhi
• Infosys	-	Hubli
• Advanta India Pvt., Ltd	-	Hyderabad
• HSBC Software	-	Hyderabad
• IBM Manyata Software	-	Hyderabad
• Icrisat school	-	Hyderabad
• Sakshi Telugu TV Chanel	-	Hyderabad

• Xilinx Software	-	Hyderabad
• Proctor and Gamble Ltd	-	Hyderabad
• Uwezo Learning Center	-	Hyderabad
• State Bank Staff College	-	Hyderabad
• Hexagon Project	-	Hyderabad
• ADP project	-	Hyderabad
• Ramboll Project	-	Hyderabad
• NTT Data	-	Hyderabad
• Unicharm Project	-	Sricity
• Foster School	-	Hyderabad
• GMR office AIRPORT	-	Hyderabad
• TATA Steels.	-	Jemshedpur
• Sarovar Portico	-	Junagadh
• L&T office	-	Kolkata
• Delhi Public School	-	Kolkata
• Royal Culcutta Turf Club	-	Kolkata
• Loreal Project	-	Kolkata
• Acropolis Project	-	Kolkata
• Samsung Project	-	Kolkata
• Colliers International	-	Kolkata
• PWC	-	Kolkata
• Fairfield Marriott	-	Kolkata
• Curry Twist Restaurant	-	Mumbai
• GTL Limited	-	Mumbai
• Platina ,BKC	-	Mumbai
• Skyline Recreation Club Pvt.Ltd	-	Mumbai
• Godrej & Boyce Pvt.Ltd	-	Mumbai
• Shri Brahmakshatriya Trust	-	Mumbai
• Lodha Splendora Project	-	Mumbai
• Kanakia Space Office	-	Mumbai
• Waghmore Project	-	Mumbai
• Anj Project	-	Mumbai
• Henkel Adhesive Technology Ltd	-	Mumbai
• Fun & Joy	-	Mumbai
• Lodha Palava Sector 4	-	Mumbai
• Dholera Smart City	-	Mumbai
• Sea Yah	-	Mumbai
• Della Adventures & Resorts	-	Mumbai
• Woodland	-	Mumbai
• Jet Airways Training Center	-	Mumbai
• Volkswagen Office	-	Pune
• Lodha Belmondo Project	-	Pune
• Volkawagen project 2	-	Pune
• IBM	-	Pune
• Bharat Forge	-	Pune
• Anirudham Gabhara Door	-	Pune
• TIAA	-	Pune
• Marwadi Education Institutions	-	Rajkot
• SRK Destiny office Ltd	-	Vizag

SRILANKA

• Shangri-La Hotel	-	Colombo
• Golden Star Beach Hotel	-	Colombo
• Talpe Villa Residence	-	Colombo

BHUTAN

• Le Meridian Hotel	-	Thimpu
---------------------	---	--------

BANGLADESH

• Six Season Hotel	-	Dhaka
• Sultan Hotel	-	Dhaka
• Crimson Glory Project	-	Dhaka
• Tilottama Group Project	-	Dhaka
• Karishma Conference Hall	-	Dhaka

NOTES

[illegible]

NOTES

[illegible]

**Mumbai Design Centre:**

Haji Moosa Patrawala Ind.(SOBO)
Estate, Near Famous Studio,
Mahalaxmi (West), Mumbai - 400 011
Tel.: 022 6264 7100.

Mumbai Design Centre:

#2 Filix Building, Opp. Asian Paints,
L.B.S. Marg, Bhandup (West),
Mumbai - 400 078
Tel.: 022 2596 9660/
2596 9787/2594 7305

New Delhi Office & Design Centre:

D-89 , 1st Floor, Okhla Phase-I,
New Delhi - 110 020
Tel.: 011-66574999
Fax: 011-41605482

Bangalore Office & Design Centre:

Incubex Nestavera Spaces Pvt Ltd,
No:13, Langford Place, Langford Road,
Shanti Nagar, Bangalore - 560 025
Tel.: 080 4132 6116
Fax: 080 4132 6226

Bangalore**Hafele Appliances Gallery:**

No. 2/1, Shiv Manor, Langford Road,
Shantinagar, Bangalore - 560027
Tel.: 080 - 4142 6336

Hyderabad Office & Design Centre:

SJR Building - # 1-57/89/1 & 1-57/89/2
Opp Allahabad Bank, Gachibowli,
Hyderabad – 500032
Tel.: 040 29557578 / 040 29557588

Kolkata Design Centre:

PS PACE, Premises No. 1/1A,
Mahendra Roy Lane, Topsia,
Kolkata - 700 046
Tel.: 033 40086814 / 033 40089268
Fax: 033 24988020

Kolkata Office:

Office No. 1001, PS Continental,
10th Floor, 83/2/1 Topsia Road,
Near Vishwakarma Building.
South Kolkata - 700046
Tel: 033-2285 0104 /
033-2285 0105 / 033-2285 0106

Chennai Office & Design Centre:

1st Floor No.24, College Road,
Nungambakkam, Chennai - 600 006
Tel.: 044 - 4215 1542
Fax: 044 2446 0922

Pune Design Centre:

Showroom No. 2, Ground Floor,
F P no. 403, A/2, ICC Trade Tower,
Senapati Bapat Marg,
Shivaji Nagar, Pune -411016
Tel.: 020 2563 3301
Fax: 020 2563 3302

Pune Office:

Office No. 12, Vastushree Complex,
Survey No.587,
Near Hyde Park, Gultekdi,
Market Yard, Pune - 411 037
Tel.: 020 2426 6264
Fax: 020 2426 6274

Ahmedabad Office:

Hafele India Pvt. Ltd., Office No. 302,
3rd Floor, Shangrila Arcade, Near
Shyamal Cross Road, Satellite,
Ahmedabad - 380015
Tel.: +91 79695 55505 / 8866220505

Cochin Office:

Jomer Symphony, 5th Floor, 48/1744
C34, Chalikkavattom, North Ponnurunni,
Vyttila, Cochin- 682010

Sri Lanka:**Hafele Office and Design Centre:**

52, Nandana Gardens
(On Duplication Road), Colombo 04.
Tel: +94 112 500 501.
Fax: 0094 112 500 553.

Hafele Design Centre:

448, Galle Road, Rawathawatta,
Moratuwa, Sri Lanka.
Tel.: +94 112 644 600.

Hafele Boutique:

747A, Sirimawo Bandaranayaka
Mawatha, Mulgampola,
Kandy, Sri Lanka.
Tel.: +94 812 223 338.

Bangladesh Office:

2nd Floor, House - 181, Road - 2,
Mohakhali DOHS, Dhaka - 1206.
Tel.: 01844018431/ 01844018432/
01844018433/ 01844018437.

Bangladesh Design Center:

House - 106, Road - 12,
Block - E, Banani, Dhaka - 1213
Tel.: 02-48810380-81

Nepal:

UHS Holdings Pvt. Ltd.
Kathmandu-2, Gairidhara Chowk, Nepal.
Mob.: +977 9802338800

Bhutan:

SMART HOMES
Gr. Floor, Druk Building (Opp Helipad)
Babesa -Thimpu Expressway, Thimpu
Tel.: +975-2-333419
Mob.: +975-77277615, 17839717,
77114228,1760063,17669840



Mumbai Corporate Office:

Office No. 3, Building "A", BETA,
I Think Techno Campus, Off J.V.L.R,
Opp. Kanjurmarg East, Mumbai – 400 042.
Tel.: 022 6142 6100 • Fax: 022 6702 0531.

For Enquiries SMS "HAFELE" to 56070

Toll Free Customer Care: 1800 266 6667
Customer Care WhatsApp: +91 97691 11122
customercare@hafeleindia.com
info@hafeleindia.com

Follow us on

