

HÄFELE



www.hafeleindia.com

METALLA 510 HINGES



HINGES

3

Hinges



Designed with perfection and conceived to perform, the new Metalla 510 Hinge Range by Häfele adds efficient functionality to your kitchen cabinets. The standard application hinges, from this range, for shutters made from wood or with wide aluminium frame come with an opening angle of 105° and constitute full-overlay, half-overlay and inset applications respectively. For shutters made with narrow aluminium profile, the range houses a special aluminium profile hinge with the same opening angle. Metalla 510 also includes a 155° wide-angle application hinge for cabinets with internal drawers or shelves.

All hinges from within this range come equipped with an integrated soft-close mechanism in the hinge cup which can be activated via a damper shifter, at an opening angle of either 30° or 10°, for a smooth and noiseless closing. Having cycle tested for 200,000 times, these hinges meet and exceed the LGA certification requirements ensuring high operational durability. Made of high-quality steel with an attractive nickel plated finish, the Metalla 510 hinges are salt spray tested for 48 hours guaranteeing a high degree of corrosion resistance (EN 15570 Level 3).

HINGES

INFORMATION

Number of concealed hinges per door

The values in the table are sample measurements.
Trial mounting is recommended.

The number of concealed hinges per door depends on:

- > Door width and height
- > Door weight
- > Door material

Example: According to the diagram three concealed hinges have to be fitted with a door height of 1,600 mm and a door weight of 6–9 kg.

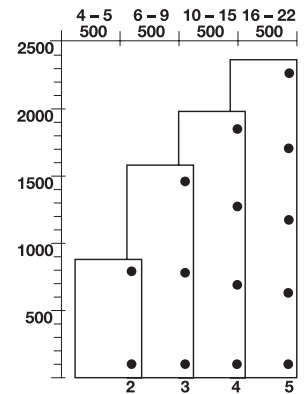

Mounting

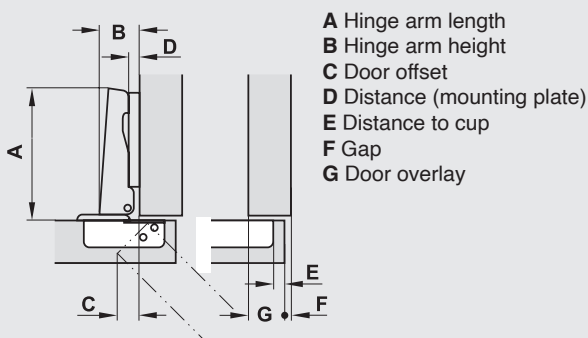

Full overlay mounting
Concealed hinge with straight hinge arm

Half overlay mounting
Concealed hinge with cranked hinge arm

Inset mounting
Concealed hinge with high cranked hinge arm

Drilling pattern for cup fixing

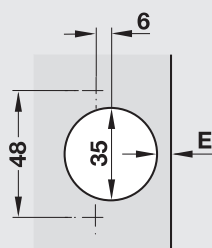

Drilling pattern 48 / 6 for Metalla 510 105°
Standard Hinge and 155° Wide Angle Hinge

HINGES - FOR WOODEN DOORS

Metalla 510 105° Standard Application Hinges



- > With integrated soft closing mechanism in hinge cup
- > The soft closing mechanism can be activated at an opening angle of 30° or 10° via damper shifter



3

Hinges

Door thickness	Distance to cup E mm			
	3.0	4.0	5.0	6.0
15	1.0	0.9	0.9	0.9
16	1.0	1.0	1.0	1.0
17	1.2	1.2	1.1	1.1
18	1.4	1.3	1.2	1.2
19	1.6	1.5	1.5	1.4
20	1.9	1.8	1.8	1.7
21	2.3	2.2	2.1	2.0
22	2.8	2.6	2.5	2.4
23	4.0	3.2	3.0	2.9
24	5.3	4.3	3.6	3.4
Minimum gap F				
Rounding off the edge of door reduces the given values.				

- > Material: Steel: cup and hinge arm
- > Finish: Nickel plated
- > Cup fixing: For screw fixing
- > Installation: Door to cabinet for quick fixing with SM quick fixing system
- > Drilling depth: Hinge cup 12 mm
- > Adjustment facility: Side adjustment -1.5 to +3 mm, Height adjustment -2 to +2 mm, Depth adjustment with mounting plate +2.8 mm
- > Opening Angle: 105°
- > Door thickness: 15-24 mm

Full overlay mounting

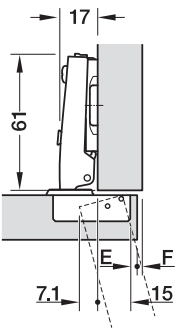

Door overlay mm									
12	13	14	15	16	17	18	19		
				3	4	5	6	2	
Distance to cup mm				E					
				Mounting plate distance mm					

Standard Set	Article. No.
Metalla 510 105° Full Overlay Hinge, Drilling Pattern 48/6	311.46.591
Individual Components	
105° Full Overlay Hinge, for Screw Fixing	329.14.300
Cruciform Mounting Plate, 2 mm	329.87.000

HINGES - FOR WOODEN DOORS

Metalla 510 105° Standard Application Hinges

Half overlay mounting/twin mounting

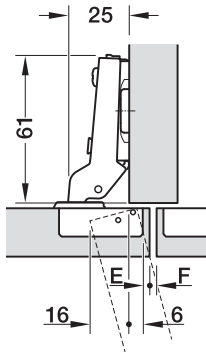

Door overlay mm								
3	4	5	6	7	8	9	10	
				3	4	5	6	2
Distance to cup E mm				Mounting plate distance mm				

Standard Set	Article. No.
Metalla 510 105° Half Overlay Hinge, Drilling Pattern 48/6	311.46.590
Individual Components	
105° Half Overlay Hinge, for Screw Fixing	329.14.301
Cruciform Mounting Plate, 2 mm	329.87.000

Inset mounting

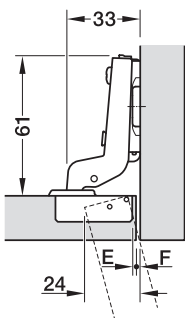

Door overlay mm								
		-5	-4	-3	-2	-1	0	
				3	4	5	6	4
Distance to cup E mm				Mounting plate distance mm				

Standard Set	Article. No.
Metalla 510 105° Inset Hinge, Drilling Pattern 48/6	311.46.592
Individual Components	
105° Inset Hinge, for Screw Fixing	329.14.302
Cruciform Mounting Plate, 4 mm	329.87.001

Metalla 510 Cruciform Mounting Plates -With Quick Fixing System

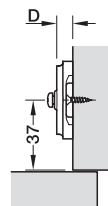
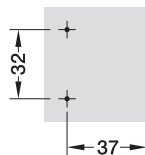
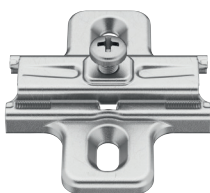

> Material:	Steel
> Finish:	Nickel plated
> Adjustment facility:	Height adjustment ± 2 mm via slot
> Edge Distance:	37 mm

Distance D mm	Article. No.
2	329.87.000
4	329.87.001

HINGES - FOR WOODEN DOORS

Metalla 510 155° Wide Angle Hinge for Cabinets with Internal Drawers or Shelves

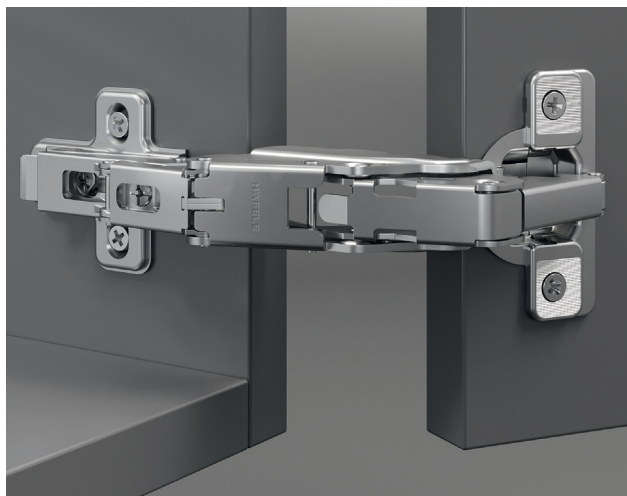

- > Required drilling depth for hinge cup only 8 mm
- > 0-door offset for use with internal pull outs or extending trays
- > With integrated soft closing mechanism in hinge cup



3

Door thickness	Distance to cup E mm						
	3.0	4.0	5.0	6.0	7.0	8.0	9.0
16	0.0	0.0	0.0	0.0	0.0	0.0	0.0
18	0.0	0.0	0.0	0.0	0.0	0.0	0.0
20	0.0	0.0	0.0	0.0	0.0	0.0	0.0
22	0.0	0.0	0.0	0.0	0.0	0.0	0.0
24	0.0	0.0	0.0	0.0	0.0	0.0	0.15
25	0.10	0.15	0.20	0.25	0.30	0.35	0.55
26	0.40	0.45	0.50	0.60	0.70	0.85	1.20
27	0.75	0.85	0.95	1.10	1.30	120° 1.70	100° 2.15
28	1.20	1.35	120° 1.70	120° 1.95	100° 2.30	100° 2.80	92° 3.90
Minimum gap F							
Rounding off the edge of door reduces the given values.							

- > Material: Zinc alloy: cup, steel: hinge arm
- > Finish: Nickel plated
- > Cup fixing: For screw fixing
- > Installation: Door to cabinet for quick fixing with SM quick fixing system
- > Drilling depth: Hinge cup with soft closing mechanism: 13.5 mm
- > Adjustment facility: Side adjustment -1.5 to +4.5 mm, Height adjustment -2 to +2 mm, Depth adjustment with mounting plate +2.8 mm
- > Opening Angle: 155°
- > Door thickness: 16-28 mm

Full overlay mounting

Door overlay mm															
9	10	11	12	13	14	15	16	17	18	19	20	21	22	23	
						3	4	5	6	7	8				2
Distance to cup E mm						Mounting plate distance mm									

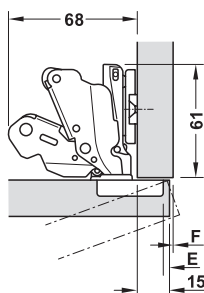

Metalla 510 Cruciform Mounting Plate -With Quick Fixing System

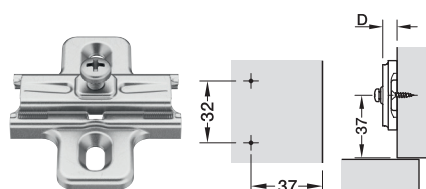

Standard Set	Article. No.
Metalla 510 155° Full Overlay Wide Angle Hinge, Drilling Pattern 48/6	311.46.594
Individual Components	
155° Full Overlay Hinge, for Screw Fixing	329.14.207
Cruciform Mounting Plate, 2 mm	329.87.000

- > Material: Steel
- > Finish: Nickel plated
- > Adjustment facility: Height adjustment ± 2 mm via slot
- > Edge Distance: 37 mm

Distance D mm	Article. No.
2	329.87.000

HINGES - FOR NARROW ALUMINIUM PROFILED DOORS

Metalla 510 105° Narrow Aluminium Profile Hinge (For Frame Width: 19 mm)



 Full overlay mounting



> With two silicone oil dampers integrated in hinge cup



- > Material: Zinc alloy: cup, steel: hinge arm
- > Finish: Nickel plated
- > Cup fixing: For screw fixing
- > Installation: Door to cabinet for quick fixing with SM quick fixing system
- > Drilling depth: Hinge cup 12.5 mm
- > Adjustment facility: Side adjustment from -1.5 to +4.5 mm (via Hinge),
Height Adjustment : 2 mm (via Mounting Plate),
Depth Adjustment : Upto 2.8 mm (via Mounting Plate)
- > Opening Angle: 105°
- > Door thickness: 20 mm

3

Hinges

Standard Set	Article. No.
Metalla 510 105° Narrow Aluminium Profile Hinge (For Frame Width: 19 mm)	311.46.593
Individual Components	
105° Full Overlay Narrow Aluminium Profile Hinge, for Screw Fixing	329.14.850
Cruciform Mounting Plate, 2 mm	329.87.000
Cover Cap	329.32.620

Cover Caps for Metalla 510 SM



- > Material: Steel
- > Finish: Nickel plated
- > Suitable for: 105° concealed hinges

Distance D mm	Article. No.
Cover cap for hinge cup	329.32.630
Cover cap for Hinge Arm	329.32.640

Construction dimensions

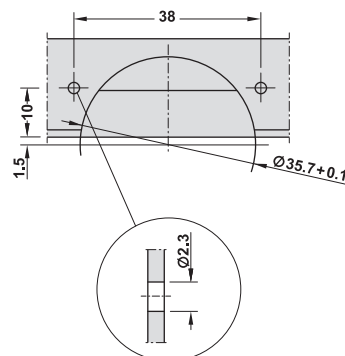

Metalla 510 Cruciform Mounting Plate -With Quick Fixing System

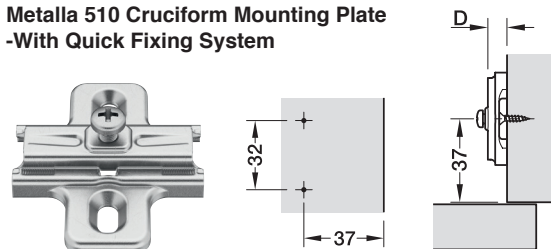

- > Material: Steel
- > Finish: Nickel plated
- > Adjustment facility: Height adjustment ± 2 mm via slot
- > Edge Distance: 37 mm

Distance D mm	Article. No.
2	329.87.000

**Mumbai Design Centre:**

Haji Moosa Patrawala Ind.(SOBO)
Estate, Near Famous Studio,
Mahalaxmi (West), Mumbai - 400 011
Tel.: 022 6264 7100.

Mumbai Design Centre:

#2 Filix Building, Opp. Asian Paints,
L.B.S. Marg, Bhandup (West),
Mumbai - 400 078
Tel.: 022 2596 9660/
2596 9787/2594 7305

New Delhi Office & Design Centre:

D-89 , 1st Floor, Okhla Phase-I,
New Delhi - 110 020
Tel.: 011-66574999
Fax: 011-41605482

Bangalore Office & Design Centre:

Incubex Nestavera Spaces Pvt Ltd,
No:13, Langford Place, Langford Road,
Shanti Nagar, Bangalore - 560 025
Tel.: 080 4132 6116
Fax: 080 4132 6226

Bangalore**Hafele Appliances Gallery:**

No. 2/1, Shiv Manor, Langford Road,
Shantinagar, Bangalore - 560027
Tel.: 080 - 4142 6336

Hyderabad Office & Design Centre:

SJR Building - # 1-57/89/1 & 1-57/89/2
Opp Allahabad Bank, Gachibowli,
Hyderabad – 500032
Tel.: 040 29557578 / 040 29557588

Kolkata Design Centre:

PS PACE, Premises No. 1/1A,
Mahendra Roy Lane, Topsia,
Kolkata - 700 046
Tel.: 033 40086814 / 033 40089268
Fax: 033 24988020

Kolkata Office:

Office No. 1001, PS Continental,
10th Floor, 83/2/1 Topsia Road,
Near Vishwakarma Building.
South Kolkata - 700046
Tel: 033-2285 0104 /
033-2285 0105 / 033-2285 0106

Chennai Office & Design Centre:

1st Floor No.24, College Road,
Nungambakkam, Chennai - 600 006
Tel.: 044 - 4215 1542
Fax: 044 2446 0922

Pune Design Centre:

Showroom No. 2, Ground Floor,
F P no. 403, A/2, ICC Trade Tower,
Senapati Bapat Marg,
Shivaji Nagar, Pune -411016
Tel.: 020 2563 3301
Fax: 020 2563 3302

Pune Office:

Office No. 12, Vastushree Complex,
Survey No.587,
Near Hyde Park, Gultekdi,
Market Yard, Pune - 411 037
Tel.: 020 2426 6264
Fax: 020 2426 6274

Ahmedabad Office:

Hafele India Pvt. Ltd., Office No. 302,
3rd Floor, Shangrila Arcade, Near
Shyamal Cross Road, Satellite,
Ahmedabad - 380015
Tel.: +91 79695 55505 / 8866220505

Cochin Office:

Jomer Symphony, 5th Floor, 48/1744
C34, Chalikkavattom, North Ponnurunni,
Vyttila, Cochin- 682010

Sri Lanka:**Hafele Office and Design Centre:**

52, Nandana Gardens
(On Duplication Road), Colombo 04.
Tel: +94 112 500 501.
Fax: 0094 112 500 553.

Hafele Design Centre:

448, Galle Road, Rawathawatta,
Moratuwa, Sri Lanka.
Tel.: +94 112 644 600.

Hafele Boutique:

747A, Sirimawo Bandaranayaka
Mawatha, Mulgampola,
Kandy, Sri Lanka.
Tel.: +94 812 223 338.

Bangladesh Office:

2nd Floor, House - 181, Road - 2,
Mohakhali DOHS, Dhaka - 1206.
Tel.: 01844018431/ 01844018432/
01844018433/ 01844018437.

Bangladesh Design Center:

House - 106, Road - 12,
Block - E, Banani, Dhaka - 1213
Tel.: 02-48810380-81

Nepal:

UHS Holdings Pvt. Ltd.
Address: Kathmandu-2, Gairidhara
Chowk, Nepal.
Mob.: +977 9802338800

Bhutan:

Smart Homes
Gr. Floor, Druk Building (Opp Helipad)
Babesa -Thimpu Expressway, Thimpu
Tel.: +975-2-333419
Mob.: +975-77277615, 17839717,
77114228,1760063,17669840

HAFELE

Mumbai Corporate Office:
Office No. 3, Building "A", BETA,
I Think Techno Campus, Off J.V.L.R.,
Opp. Kanjurmarg East, Mumbai – 400 042.
Tel.: 022 6142 6100 | Fax: 022 6702 0531.

For Enquiries SMS "HAFELE" to 56070
Toll Free Customer Care: 1800 266 6667
Customer Care WhatsApp: +91 97691 11122
customer@hafeleindia.com
info@hafeleindia.com

Follow us on

